

# CT40

# CT40 XP

# RUGGED MOBILE COMPUTER

Configuration Guide

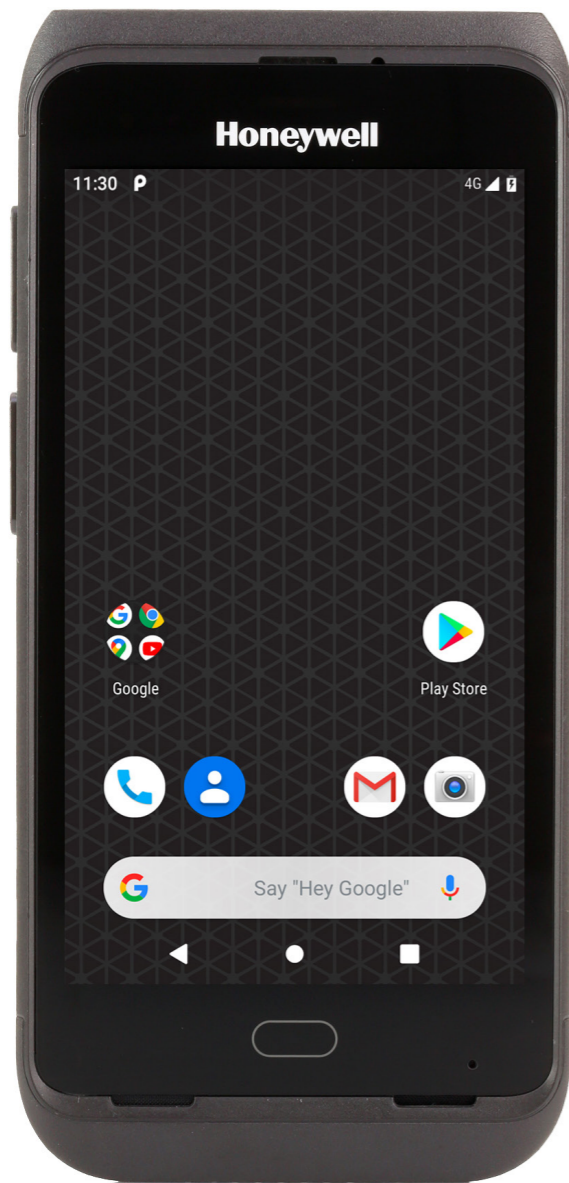

**CT40**

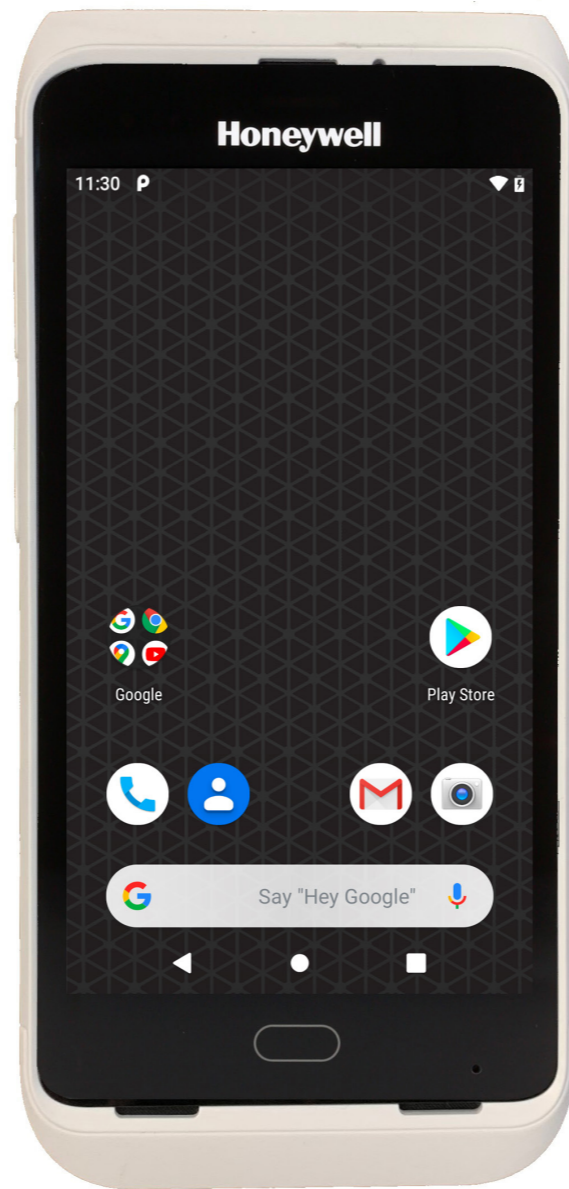

**CT40 HEALTHCARE**

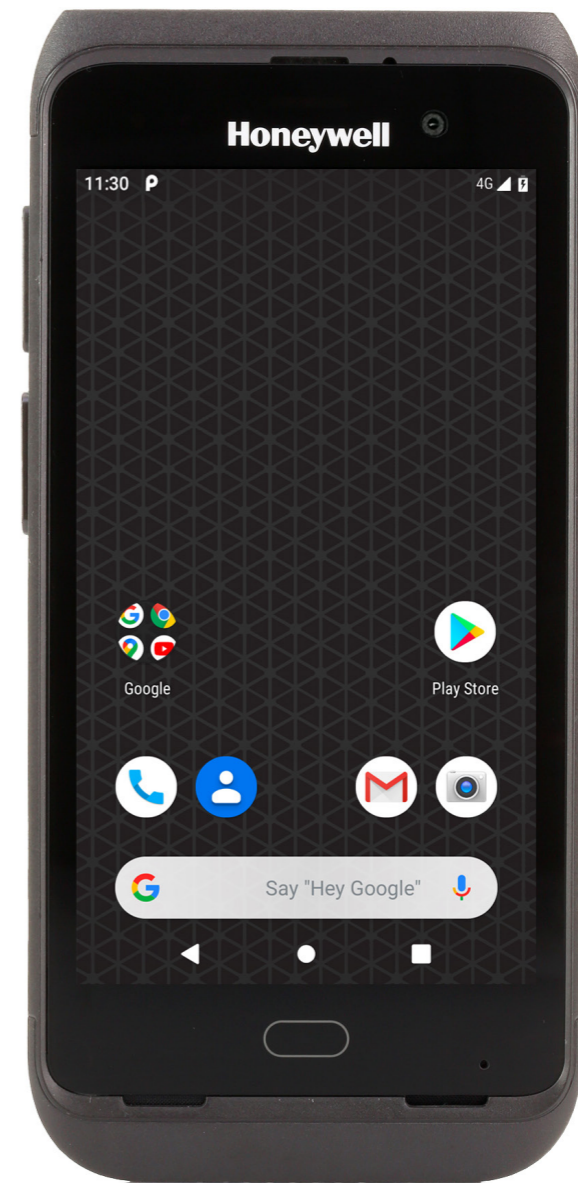

**CT40 XP**

THE  
FUTURE  
IS  
WHAT  
WE  
MAKE IT

**Honeywell**

# TABLE OF CONTENTS

- 2 CT40 FEATURE OVERVIEW**
  - N3601 STANDARD RANGE
  - N6703 STANDARD RANGE
  - DISINFECTANT READY HOUSING - N6703 STANDARD RANGE
  - N6803 FLEXRANGE™ NEAR/ FAR RANGE
  - HEALTHCARE - N6700 GREEN LINEAR LED AIMER - STANDARD RANGE
  
- 6 CT40 CONFIGURATION MAP**
  
- 7 CT40 XP FEATURE OVERVIEW**
  - N6703 STANDARD RANGE
  - N6803 FLEXRANGE™ NEAR/ FAR RANGE
  - DISINFECTANT READY HOUSING - N6703 STANDARD RANGE
  - DISINFECTANT READY HOUSING - N6803 FLEXRANGE™ NEAR/ FAR RANGE
  - HEALTHCARE - N6700 GREEN LINEAR LED AIMER - STANDARD RANGE
  
- 10 CT40 XP CONFIGURATION MAP**
  
- 11 HONEYWELL EDGE SERVICES**
  - CT40 / CT40 XP - REPAIR SERVICES COVERAGE
  
- 14 CT40 / CT40 XP SOFTWARE**
  - DEVICE CLIENT PACK
  
- 15 CT40 / CT40 XP SCANNING**
  - SCAN HANDLE SIDE BY SIDE COMPARISON
  - OPTION 1 - SCAN HANDLE
  - OPTION 2 - SCAN HANDLE WITH PROTECTIVE BOOT
  - OPTION 3 - SCAN HANDLE FOR USE WITH CAMERA
  
- 19 CT40 / CT40 XP DESKTOP COMMUNICATIONS**
  - OPTION 1 – PORTABLE - NON-BOOTED
  - OPTION 2 – PORTABLE - NON-BOOTED OR BOOTED
  - OPTION 3 – CT40 XP USB TYPE C ON-THE-GO (OTG) DESKTOP
  - OPTION 4 – CT40 XP USB TYPE C ON-THE-GO (OTG) VEHICLE
  - OPTION 5 – FIXED
  - OPTION 6 – FIXED WITH UNIVERSAL CUP
  - OPTION 7 – DISPLAY BASE
  - OPTION 8 – DISPLAY BASE WITH UNIVERSAL CUP
  
- 23 CT40 / CT40 XP VEHICLE INSTALL**
  - OPTION 1 – PORTABLE/ SUB CONTRACTOR INSTALL
  - OPTION 2 – PORTABLE/ SUB CONTRACTOR INSTALL
  - OPTION 3 - FIXED VEHICLE INSTALL WITH DIRECT CONNECTION TO VEHICLE BATTERY
  - OPTION 4 - FIXED VEHICLE INSTALL WITH DIRECT CONNECTION TO VEHICLE BATTERY/ FUSE BLOCK
  - OPTION 5 - FIXED VEHICLE INSTALL WITH THOR DC/DC CONVERTER
  - CT40 VEHICLE DOCK 360 DEGREE VIEW
  
- 28 CT40 / CT40 XP CHARGING AND COMMUNICATION**
  - OPTION 1 - NON-BOOTED QUAD CHARGER
  - OPTION 2 - NON-BOOTED QUAD CHARGER WITH UNIVERSAL CUP
  - OPTION 3 - BOOTED QUAD CHARGER
  - OPTION 4 - BOOTED QUAD CHARGER WITH UNIVERSAL CUP
  - OPTION 5 - QUAD BATTERY CHARGER
  
- 31 IH21 RFID READER FOR CT40 / CT40 XP**
  
- 32 CT40 HEALTHCARE CHARGING AND COMMUNICATION**
  - OPTION 1 - NON-BOOTED QUAD CHARGER WITH UNIVERSAL CUP
  - OPTION 2 - BOOTED QUAD CHARGER WITH UNIVERSAL CUP
  - OPTION 3 - CT40 HC DISPLAY BASE WITH UNIVERSAL CUP
  
- 34 CT40 / CT40 XP PROTECTIVE BOOT**
  - OPTION 1 - RUBBER BOOT
  - OPTION 2 - DOCKABLE PROTECTIVE BOOT
  
- 35 CT40 / CT40 XP HEADSET**
  
- 38 CT40 / CT40 XP WEARABLE WITH TETHERED RING SCANNER**
  - OPTION 1 - CT40 WEARABLE WITH D75E ARM BAND
  - OPTION 2 - CT40 WEARABLE - ARM BAND WRIST PAD
  
- 39 MISCELLANEOUS**
  - OPTIONAL PARTS
  - MICRO-SD CARDS
  - AC CORDS



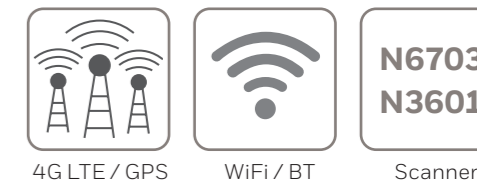

# CT40 FEATURE OVERVIEW

## N3601 Standard Range

## N6703 Standard Range

Included in the box:

- CT40 Mobile Computer
- Battery (318-055-015)
- Hand strap

(Stylus is NOT included, but available to order separately as an accessory)



N6703 Standard Range

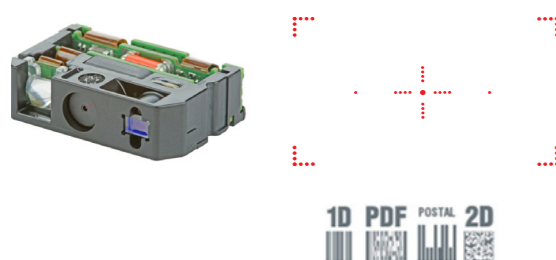

N3601 Standard Range

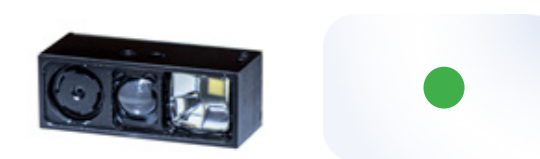

3.5mm Audio Jack  
(WiFi Models Only CT40-LON-xxxxxAx)

### CT40 Android - 4G WWAN - N6703 - 4GB RAM/ 32GB Flash

**CT40-L1N-27C11Bx** CT40, Android, WWAN, 802.11 a/b/g/n/ac/r/k/mc, 1D/2D Imager SR (N6703), 4GB/32GB Memory, 13MP Camera, BT 5.0, NFC, Gen 2 Battery 4,040 mAh

### CT40 Android - WiFi Only - N6703 - 4GB RAM/ 32GB Flash

**CT40-LON-27C11Ax** CT40, Android, WLAN, 802.11 a/b/g/n/ac/r/k/mc, 1D/2D Imager SR (N6703), 4GB/32GB Memory, 13MP Camera, BT 5.0, NFC Gen 2 Battery 4,040 mAh, 3.5mm Audio Jack  
(Does not include headset, order CT40-HDST-35MM separately)

### CT40 Android - 4G WWAN - N3601 - 2GB RAM/ 32GB Flash

**CT40-L1N-1NC11Bx** CT40, Android, WWAN, 802.11 a/b/g/n/ac/r/k/mc, 1D/2D Imager SR (N3601), 2GB/32GB Memory, 13MP Camera, BT 5.0, NFC, Gen 2 Battery 4,040 mAh

### CT40 Android - WiFi Only - N3601 - 2GB RAM/ 32GB Flash

**CT40-LON-1NC11Ax** CT40, Android, WLAN, 802.11 a/b/g/n/ac/r/k/mc, 1D/2D Imager SR (N3601), 2GB/32GB Memory, 13MP Camera, BT 5.0, NFC, Gen 2 Battery 4,040 mAh, 3.5mm Audio Jack  
(Does not include headset, order CT40-HDST-35MM separately)

(Note: x = Domain, select appropriate Domain from Configuration Map on page 6)

### Honeywell Repair Services

SVCCT40-SG3N

CT40 / CT40 XP, Edge Service, Gold Maintenance Contract, 3 Year, New Contract

ADD SVCREPLACE-MOB3

AddOn, Edge Service, Device Replacement, Mobility, 3 Year



# CT40 FEATURE OVERVIEW

## Disinfectant Ready Housing - N6703 Standard Range

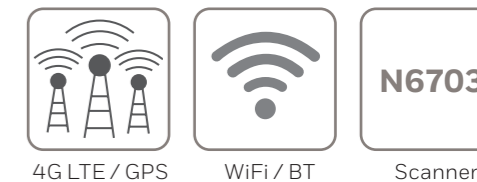

Included in the box:

- CT40 Mobile Computer
- Battery (318-055-D67)
- Healthcare Hand strap

(Stylus is NOT included, but available to order separately as an accessory)

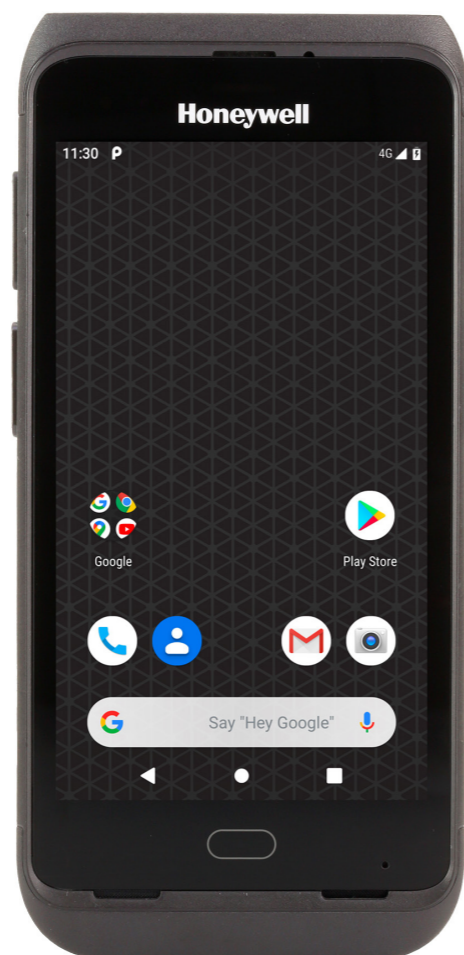

N6703 Standard Range

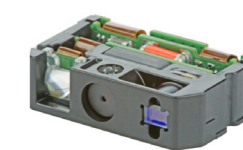

No Audio Jack

(WWAN Models CT40-L1N-xxxxxDx)

3.5mm Audio Jack  
(WiFi Models Only CT40-LON-xxxxxDx)

### CT40 Android - 4G WWAN - N6703 - 4GB RAM/ 32GB Flash

#### CT40-L1N-27C11Dx

CT40 Disinfectant Ready, Android, WWAN, 802.11 a/b/g/n/ac/r/k/mc, 1D/2D Imager SR(N6703), 4GB/32GB Memory, 13MP Camera, BT 5.0, NFC, Battery 4,020 mAh Disinfectant Ready Cover, Healthcare hand strap

### CT40 Android - WiFi Only - N6703 - 4GB RAM/ 32GB Flash

#### CT40-LON-27C11Dx

CT40 Disinfectant Ready, Android, WLAN, 802.11 a/b/g/n/ac/r/k/mc, 1D/2D Imager SR(N6703), 4GB/32GB Memory, 13MP Camera, BT 5.0, NFC, Battery 4,020 mAh Disinfectant Ready Cover, Healthcare hand strap

(Note: x = Domain, select appropriate Domain from Configuration Map on page 6)

#### Honeywell Repair Services

SVCCT40-SG3N

CT40 / CT40 XP, Edge Service, Gold Maintenance Contract, 3 Year, New Contract

ADD SVCREPLACE-MOB3

AddOn, Edge Service, Device Replacement, Mobility, 3 Year



# CT40 FEATURE OVERVIEW

## N6803 FlexRange™ Near/ Far Range

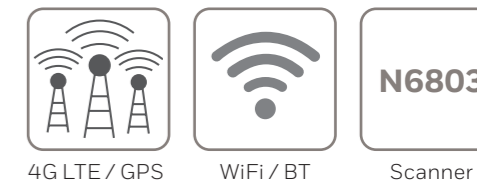

Included in the box:

- CT40 Mobile Computer
- Battery (318-055-015)
- Hand strap

(Stylus is NOT included, but available to order separately as an accessory)

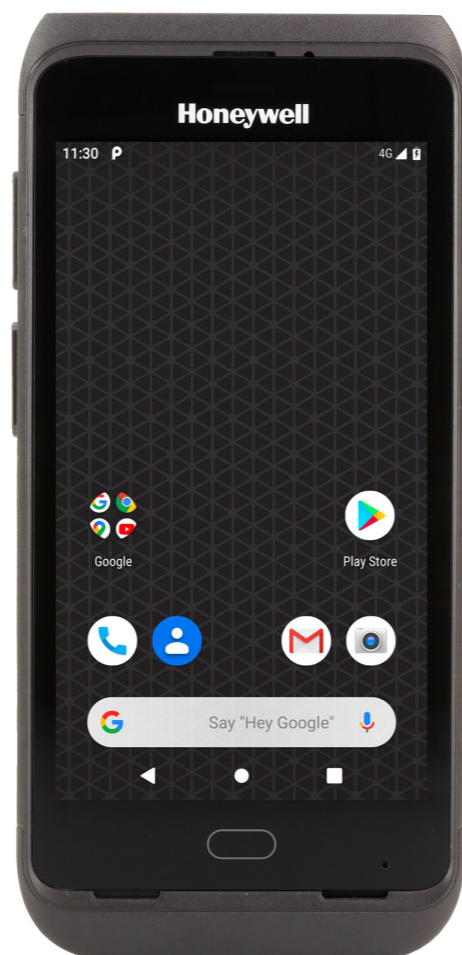

N6803 FlexRange™

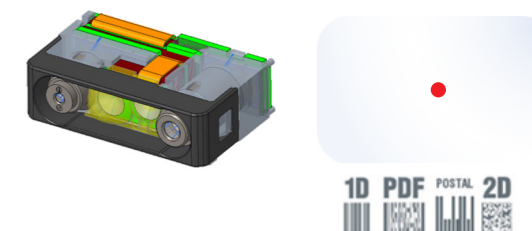

3.5mm Audio Jack  
(WiFi Models Only CT40-LON-xxxxAx)



No Audio Jack  
(WWAN Models CT40-L1N-xxxxBx)

### CT40 Android - 4G WWAN - N6803 FlexRange - 4GB RAM/ 32GB Flash

#### CT40-L1N-28C11Bx

CT40, Android, WWAN, 802.11 a/b/g/n/ac/r/k/mc, 1D/2D Imager SR (N6803) FlexRange, 4GB/32GB Memory, 13MP Camera, BT 5.0, NFC, Gen 2 Battery 4,040 mAh

### CT40 Android - WiFi Only - N6803 FlexRange - 4GB RAM/ 32GB Flash

#### CT40-LON-28C11Ax

CT40, Android, WLAN, 802.11 a/b/g/n/ac/r/k/mc, 1D/2D Imager SR (N6803) FlexRange, 4GB/32GB Memory, 13MP Camera, BT 5.0, NFC, Battery 4,040 mAh, Metal battery latch button, 3.5mm Audio Jack  
(Does not include headset, order CT40-HDST-35MM separately)

(Note: x = Domain, select appropriate Domain from Configuration Map on page 6)

#### Honeywell Repair Services

SVCCT40-SG3N

CT40 / CT40 XP, Edge Service, Gold Maintenance Contract, 3 Year, New Contract

ADD SVCREPLACE-MOB3

AddOn, Edge Service, Device Replacement, Mobility, 3 Year



# CT40 FEATURE OVERVIEW

## Healthcare - N6700 Green Linear LED Aimer - Standard Range

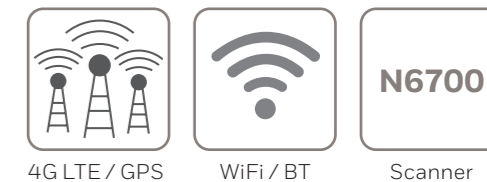

Included in the box:

- CT40 Mobile Computer
- Battery (318-055-017)

(Stylus and Hand strap are NOT included, but available to order separately as an accessory)



N6700



### CT40 Android - WWAN - N6700 - 4GB RAM/ 32GB Flash - Healthcare

#### CT40-L1N-2LC11Hx

CT40, Android, WWAN, 802.11 a/b/g/n/ac/r/k/mc, 1D/2D Imager SR (N6700) with Linear LED Aimer, 4GB/32GB Memory, 13MP Camera, BT 5.0, NFC, Gen 2 Battery 4,020 mAh, White Healthcare without Handstrap.

### CT40 Android - WiFi Only - N6700 - 4GB RAM/ 32GB Flash - Healthcare

#### CT40-LON-2LC11Hx

CT40, Android, WLAN, 802.11 a/b/g/n/ac/r/k/mc, 1D/2D Imager SR (N6700) with Linear LED Aimer, 4GB/32GB Memory, 13MP Camera, BT 5.0, NFC, Gen 2 Battery 4,020 mAh, White Healthcare without Handstrap.

(Note: x = Domain, select appropriate Domain from Configuration Map on page 6)

#### Honeywell Repair Services

SVCCT40-SG3N

CT40 / CT40 XP, Edge Service, Gold Maintenance Contract, 3 Year, New Contract



ADD SVCREPLACE-MOB3

AddOn, Edge Service, Device Replacement, Mobility, 3 Year



# CT40 CONFIGURATION MAP

## Android

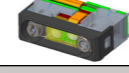
CT40-										DESCRIPTION	NOTES	
BLUETOOTH/WIFI	WWAN	NFC	MEMORY	IMAGER	CAMERA	OPERATING SYSTEM	APPLICATION	OPTIONS	DOMAIN			
L											802.11 a/b/g/n/ac + Bluetooth 5.0	IEEE 802.11 a/b/g/n/ac/r/k/mc ; Wi-Fi certified V5.0 Bluetooth and BLE Supported Bluetooth Profiles: HFP, PBAP, A2DP, AVRCP, OPP, SPP, GATT
	0										No WWAN	
	1										LTE (4G) GPS, UMTS/HSPA+ (3G) GSM/GPRS/EDGE	WWAN RADIO (ATT/VZW/SPRINT/TMO/NA/EU) LTE (FDD) – BANDS 1,2,3,4,5,7,8,12,13,17,19,20,25,26,28,29 / LTE (TDD) – BANDS 38,39,40,41 UMTS/HSPA+ (3G) – BANDS 1, 2, 4, 5, 6, 8, 9, 19 / GSM/GPRS/EDGE QUAD-BAND (850/900/1800/1900 MHZ)
		N									Near Field Communications (NFC)	
			--									
			1								2GB RAM, 32GB Flash Memory	2.2 GHz Qualcomm Snapdragon™ 660 octa-core
			2								4GB RAM, 32GB Flash Memory	2.2 GHz Qualcomm Snapdragon™ 660 octa-core
				L							1D/2D Imager (N6700) – Standard Range	
				N							1D/2D Imager (N3601) – Standard Range	
				7							1D/2D Imager (N6703SR) – Standard Range	
				8							1D/2D Imager (N6803FR) – FlexRange™	
					C						Camera	13MP Rear Camera
						1					Android (GMS)	Google Mobile Services (GMS) certified – Play Store
						2					Android (Non-GMS)	
							1				Standard Software Build	
								0			Standard	
								A			Audio Jack – New Battery Latch	3.5mm Audio Jack - supports PTT, VOIP – Only available on WiFi Only models (CT40-L0-xxxxxxx)
								B			No Audio Jack – New Battery Latch	
								D			Disinfectant Ready Housing - Honeywell Grey Colour	Disinfectant Ready Housings (DRHs). DRHs utilize plastics designed to withstand the harshness of frequent cleaning with disinfectants without compromising the lifespan of the equipment.
								H			Healthcare - White	CT40 Healthcare is made from disinfectant-ready materials that are designed to withstand frequent cleaning using approved disinfecting and sanitizing agents.
									A		ANZ & Argentina	Argentina, Australia, New Zealand
									E		WorldWide	Austria, Belgium, Brazil, Bulgaria, Chile, Columbia, Croatia, Cyprus, Czech Republic, Denmark, Dominican Republic, Ecuador, El Salvador, Estonia, Finland, France, Germany, Greece, Hong Kong, Hungary, Iceland, Ireland, Italy, Japan, Latvia, Liechtenstein, Lithuania, Luxembourg, Malta, Netherlands, Norway, Peru, Philippines, Poland, Portugal, Romania, Singapore, Slovakia, Slovenia, South Korea, Spain, Sweden, Switzerland, Thailand, United Kingdom, Venezuela
									F		FCC	USA, Canada, Guatemala, Mexico, Panama, Puerto Rico, Taiwan
									M		Miscellaneous 2.4GHz	Egypt, Honduras, Indonesia, Malaysia



# CT40 XP FEATURE OVERVIEW

## N6703 Standard Range

## N6803 FlexRange™ Near/ Far Range

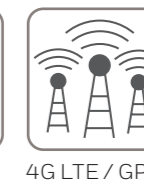
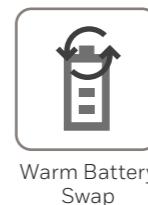

Included in the box:

- CT40 Mobile Computer
- Battery (318-055-015)
- Hand strap

(Stylus is NOT included, but available to order separately as an accessory)

N6703 Standard Range



No Audio Jack / USB Type C  
(WWAN Models CT40P-L1N-xxxxxBx)



N6803 FlexRange™



3.5mm Audio Jack / USB Type C  
(WiFi Models Only CT40P-LON-xxxxxAx)

### CT40 XP Android - 4G WWAN - N6703 Standard Range - 4GB RAM/ 32GB Flash

**CT40P-L1N-27R11Bx** CT40 XP, WWAN, 4GB/32GB Memory, 5inch 1920x1080P full HD, N6703, 13MP Rear Camera/8MP Front Camera, 802.11 a/b/g/n/ac/r/k/mc, 2x2 MIMO,Bluetooth 5.0 & 2nd BLE, Android GMS, Warm Swap, IP67&65, Metal battery latch button, USB Type C OTG, PTT

### CT40 XP Android - WiFi Only - N6803 FlexRange - 4GB RAM/ 32GB Flash

**CT40P-LON-27R11Ax** CT40 XP, WLAN, 4GB/32GB Memory, 5inch 1920x1080P full HD, N6703, 13MP Rear Camera/8MP Front Camera, 802.11 a/b/g/n/ac/r/k/mc, 2x2 MIMO,Bluetooth 5.0 & 2nd BLE, Android GMS, Warm Swap, IP67&65, Metal battery latch button, 3.5mm Audio Jack, USB Type C OTG, PTT

### CT40 XP Android - 4G WWAN - N6803 FlexRange - 4GB RAM/ 32GB Flash

**CT40P-L1N-28R11Bx** CT40 XP, WWAN, 4GB/32GB Memory, 5inch 1920x1080P full HD, N6803 FlexRange, 13MP Rear Camera/8MP Front Camera, 802.11 a/b/g/n/ac/r/k/mc, 2x2 MIMO,Bluetooth 5.0 & 2nd BLE, Android GMS, Warm Swap, IP67&65, Metal battery latch button, USB Type C OTG, PTT

### CT40 XP Android - WiFi Only - N6803 FlexRange - 4GB RAM/ 32GB Flash

**CT40P-LON-28R11Ax** CT40 XP, WLAN, 4GB/32GB Memory, 5inch 1920x1080P full HD, N6803 FlexRange, 13MP Rear Camera/8MP Front Camera, 802.11 a/b/g/n/ac/r/k/mc, 2x2 MIMO,Bluetooth 5.0 & 2nd BLE, Android GMS, Warm Swap, IP67&65, Metal battery latch button, 3.5mm Audio Jack, USB Type C OTG, PTT

(Note: x = Domain, select appropriate Domain from Configuration Map on page 7)

### Honeywell Repair Services

SVCCT40-SG3N

CT40 / CT40 XP, Edge Service, Gold Maintenance Contract, 3 Year, New Contract

ADD SVCREPLACE-MOB3

AddOn, Edge Service, Device Replacement, Mobility, 3 Year



# CT40 XP FEATURE OVERVIEW

**Disinfectant Ready Housing - N6703 Standard Range**

**Disinfectant Ready Housing - N6803 FlexRange™ Near/ Far Range**

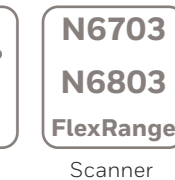

Included in the box:

- CT40 Mobile Computer
- Battery (318-055-D67)
- Healthcare Hand strap

(Stylus is NOT included, but available to order separately as an accessory)

N6703 Standard Range



No Audio Jack / USB Type C  
(WWAN Models CT40P-L1N-xxxxxBx)



N6803 FlexRange™



3.5mm Audio Jack / USB Type C  
(WiFi Models Only CT40P-LON-xxxxxAx)

### CT40 XP Android - 4G WWAN - N6703 Standard Range - 4GB RAM/ 32GB Flash

**CT40P-L1N-27R11Bx** CT40 XP, WWAN, 4GB/32GB Memory, 5inch 1920x1080P full HD, N6703, 13MP Rear Camera/8MP Front Camera, 802.11 a/b/g/n/ac/r/k/mc, 2x2 MIMO,Bluetooth 5.0 & 2nd BLE, Android GMS, Warm Swap, IP67&65, Metal battery latch button, USB Type C OTG, PTT

### CT40 XP Android - WiFi Only - N6703 Standard Range - 4GB RAM/ 32GB Flash

**CT40P-LON-27R11Ax** CT40 XP, WLAN, 4GB/32GB Memory, 5inch 1920x1080P full HD, N6703, 13MP Rear Camera/8MP Front Camera, 802.11 a/b/g/n/ac/r/k/mc, 2x2 MIMO,Bluetooth 5.0 & 2nd BLE, Android GMS, Warm Swap, IP67&65, Metal battery latch button, 3.5mm Audio Jack, USB Type C OTG, PTT

### CT40 XP Android - 4G WWAN - N6803 FlexRange - 4GB RAM/ 32GB Flash

**CT40P-L1N-28R11Bx** CT40 XP, WWAN, 4GB/32GB Memory, 5inch 1920x1080P full HD, N6803 FlexRange, 13MP Rear Camera/8MP Front Camera, 802.11 a/b/g/n/ac/r/k/mc, 2x2 MIMO,Bluetooth 5.0 & 2nd BLE, Android GMS, Warm Swap, IP67&65, Metal battery latch button, USB Type C OTG, PTT

### CT40 XP Android - WiFi Only - N6803 FlexRange - 4GB RAM/ 32GB Flash

**CT40P-LON-28R11Ax** CT40 XP, WLAN, 4GB/32GB Memory, 5inch 1920x1080P full HD, N6803 FlexRange, 13MP Rear Camera/8MP Front Camera, 802.11 a/b/g/n/ac/r/k/mc, 2x2 MIMO,Bluetooth 5.0 & 2nd BLE, Android GMS, Warm Swap, IP67&65, Metal battery latch button, 3.5mm Audio Jack, USB Type C OTG, PTT

(Note: x = Domain, select appropriate Domain from Configuration Map on page 7)

### Honeywell Repair Services

SVCCT40-SG3N

CT40 / CT40 XP, Edge Service, Gold Maintenance Contract, 3 Year, New Contract

ADD SVCREPLACE-MOB3

AddOn, Edge Service, Device Replacement, Mobility, 3 Year



# CT40 XP FEATURE OVERVIEW

## Healthcare - N6700 Green Linear LED Aimer - Standard Range

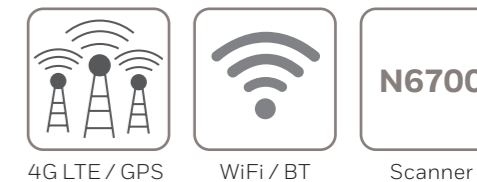

Included in the box:

- CT40 Mobile Computer
- Battery (318-055-017)

(Stylus and Hand strap are NOT included, but available to order separately as an accessory)



N6700



### CT40 Android - WWAN - N6700 - 4GB RAM/ 32GB Flash - Healthcare

#### CT40P-L1N-2LR11Hx

CT40 XP Healthcare, WWAN, 4GB/32GB Memory, 5 inch 1920x1080P full HD, N6700 with linear LED aimer, 13MP Rear Camera/8MP Front Camera, 802.11 a/b/g/n/ac/r/k/mc, 2x2 MIMO, BT5.0 & 2nd BLE, Android GMS, Smart Battery, Warm Swap, IP67&65, Metal battery latch button, PTT

### CT40 Android - WiFi Only - N6700 - 4GB RAM/ 32GB Flash - Healthcare

#### CT40P-LON-2LR11Hx

CT40 XP Healthcare, WLAN, 4GB/32GB Memory, 5 inch 1920x1080P full HD, N6700 with linear LED aimer, 13MP Rear Camera/8MP Front Camera, 802.11 a/b/g/n/ac/r/k/mc, 2x2 MIMO, BT5.0 & 2nd BLE, Android GMS, Smart Battery, Warm Swap, IP67&65, Metal battery latch button, PTT

(Note: x = Domain, select appropriate Domain from Configuration Map on page 6)

#### Honeywell Repair Services

SVCCT40-SG3N

CT40 / CT40 XP, Edge Service, Gold Maintenance Contract, 3 Year, New Contract



ADD SVCREPLACE-MOB3

AddOn, Edge Service, Device Replacement, Mobility, 3 Year



# CT40 XP CONFIGURATION MAP

## Android

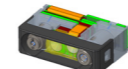
CT40P-										DESCRIPTION	NOTES	
BLUETOOTH/WIFI	WWAN	NFC	MEMORY	IMAGER	CAMERA	OPERATING SYSTEM	APPLICATION	OPTIONS	DOMAIN			
L											802.11 a/b/g/n/ac + Bluetooth 5.0	2x2 MIMO IEEE 802.11 a/b/g/n/ac/r/k/mc ; Wi-Fi certified V5.0 Bluetooth and BLE Supported Bluetooth Profiles: HFP,PBAP, A2DP, AVRCP, OPP, SPP, GATT
	0										No WWAN	
	1										LTE (4G) GPS, UMTS/HSPA+ (3G) GSM/GPRS/EDGE	WWAN RADIO (ATT/VZW/SPRINT/TMO/NA/EU) LTE (FDD) – BANDS 1,2,3,4,5,7,8,12,13,17,19,20,25,26,28,29 / LTE (TDD) – BANDS 38,39,40,41 UMTS/HSPA+ (3G) – BANDS 1, 2, 4, 5, 6, 8, 9, 19 / GSM/GPRS/EDGE QUAD-BAND (850/900/1800/1900 MHZ)
		N									Near Field Communications (NFC)	
			--									
			2								4GB RAM, 32GB Flash Memory	2.2 GHz Qualcomm Snapdragon™ 660 octa-core
				L							1D/2D Imager (N6700) – Standard Range	
				7							1D/2D Imager (N6703SR) – Standard Range	
				8							1D/2D Imager (N6803FR) – FlexRange™	
					R						13MP Rear Camera / 8MP Front Facing Camera	
						1					Android (GMS)	Google Mobile Services (GMS) certified – Play Store
						2					Android (Non-GMS)	
							1				Standard Software Build	
							D				WWAN Data Only	
								A			Audio Jack – New Battery Latch – USB Type C OTG (On The Go)	3.5mm Audio Jack - supports PTT, VOIP – Only available on WiFi Only models (CT40P-L0-xxxxxx)
								B			No Audio Jack – New Battery Latch – USB Type C OTG (On The Go)	
								D			Disinfectant Ready Housing - Honeywell Grey Colour	Disinfectant Ready Housings (DRHs). DRHs utilize plastics designed to withstand the harshness of frequent cleaning with disinfectants without compromising the lifespan of the equipment.
								H			Healthcare - White	CT40 Healthcare is made from disinfectant-ready materials that are designed to withstand frequent cleaning using approved disinfecting and sanitizing agents.
									E		WorldWide	Argentina, Australia, Austria, Belgium, Brazil, Bulgaria, Columbia, Croatia, Cyprus, Czech Republic, Denmark, Dominican Republic, Egypt, Estonia, Finland, France, Germany, Greece, Honduras, Hong Kong, Iceland, India, Indonesia, Ireland, Italy, Japan, Jordan, Kuwait, Latvia, Liechtenstein, Lithuania, Luxembourg, Malaysia, Malta, Morocco, Netherlands, New Zealand, Norway, Oman, Poland, Portugal, Qatar, Romania, Russia, Saudi Arabia, Singapore, Slovakia, Slovenia, South Africa, South Korea, Spain, Sri Lanka, Sweden, Switzerland, Thailand, UAE, Ukraine, United Kingdom, Vietnam
									F		FCC	USA, Canada, Guatemala, Mexico, Panama, Paraguay, Puerto Rico, Taiwan, Venezuela
									T		Turkey	WWAN Data Only
									I		Indonesia	WWAN 3G Radio



# HONEYWELL EDGE SERVICES

## CT40 / CT40 XP – Repair Services

Honeywell Edge Services give you the confidence of having leading-class technologies combined with service and support plans that are designed to keep you operational for longer.

### Gold Repair Services – 3 Year

The most flexible contract in the industry. The Edge Services Gold Support contract allows you to select the right coverage for your organization, and includes 5-Day Depot Repairs and:

#### Service Overview

- Repair or replacement of damaged components, wear and tear, and accidental damage.
- Flexibility to add any Add-On Service

PART NUMBER	DESCRIPTION
SVCCT40-SG3N	CT40 / CT40 XP, Edge Service, GOLD Maintenance Contract, 5 Day Turnaround, <b>3 Year</b> , New Contract

#### Add-On Accessory Replacement Service

Provides replacement chargers, docks, charging cables, or scan handles should they be damaged or stop working.

<b>ADD</b> SVCACC-MOB3	AddOn, Edge Service, Accessory Service , Mobility, <b>3 Year</b> . Service covers docks, charger cradles, scan handles
------------------------	--

#### Add-On Battery Replacement Service

Provides replacement batteries every 18 months after purchase.

<b>ADD</b> SVCBATTERY-MOB3	AddOn, Edge Service, Battery Service, Mobility, <b>3 Year</b> , 1 Replacement Battery over life of contract
----------------------------	---

#### Add-On Device Replacement Service

Replacement devices should a device be damaged beyond repair.

<b>ADD</b> SVCREPLACE-MOB3	AddOn, Edge Service, Device Replacement, Mobility, <b>3 Year</b>
----------------------------	--

#### Add-On Image Management Service

Ensures that when a device returns from being repaired, it has all the proper applications loaded back on the device.

<b>ADD</b> SVCIMAGEMGMT-MOB3	AddOn, Edge Service, Image Service, Mobility, <b>3 Year</b>
------------------------------	---

#### Add-On Spare Management Service

Manages every aspect of your spare pool.

<b>ADD</b> SVCSPAREMGMT-MOB3	AddOn, Edge Service, Advanced Exchange, Mobility, <b>3 Year</b> . Customer owned spare pool, Minimum Purchase required, contact your local Honeywell Service Representative for more information.
------------------------------	---

#### Add-On Sentinel Extended Service

Security patches and minor enhancements to legacy Android operating systems, typically added after year 3.

<b>ADD</b> SVCSSENTINEL-MOB1	Sentinel Service, <b>1 Year</b> Android Support Contract
------------------------------	--

<b>ADD</b> SVCSSENTINEL-MOB2	Sentinel Service, <b>2 Year</b> Android Support Contract
------------------------------	--

### Platinum Repair Services – 3 Year

The Edge Services Platinum Support contract is the only total support contract in the industry today offering 2-Day Depot Repairs or Spare Pool Management with 3-year contract, that includes:

#### Service Overview

- Repair or replacement of damaged components
- SVCREPLACE-MOB3 - Replacement devices should a device be damaged beyond repair
- SVCACC-MOB3 - Accessory replacement service
- SVCBATTERY-MOB3 - Battery replacement service
- PPSW-OPINTEL-PMP36 - Operational Intelligence Performance Professional licenses
- SVCSPAREMGMT-MOB3 - Spare pool management (optional, minimum quantity required)
- Telephone-based technical support
- Sentinel Extended Service that protects customers for future security updates on Android.

PART NUMBER	DESCRIPTION
SVCCT40-SP3N	CT40 / CT40 XP, Edge Service, PLATINUM, 2 Day Turnaround, 3 Year, New Contract

#### OPERATIONAL INTELLIGENCE SETUP MUST BE ORDERED WITH PLATINUM EDGE SERVICE CONTRACT

PPPS-OIPLI-SETUP	OpIntel Free Platinum Installation Basic & Professional
------------------	---





# HONEYWELL EDGE SERVICES

## CT40 / CT40 XP – Repair Services

Honeywell Edge Services give you the confidence of having leading-class technologies combined with service and support plans that are designed to keep you operational for longer.

### Gold Repair Services – 5 Year

The most flexible contract in the industry. The Edge Services Gold Support contract allows you to select the right coverage for your organization, and includes 5-Day Depot Repairs and:

#### Service Overview

- Repair or replacement of damaged components, wear and tear, and accidental damage.
- Flexibility to add any Add-On Service

PART NUMBER	DESCRIPTION
SVCCT40-SG5N	CT40 / CT40 XP, Edge Service, GOLD Maintenance Contract, 5 Day Turnaround, <b>5 Year</b> , New Contract

#### Add-On Accessory Replacement Service

Provides replacement chargers, docks, charging cables, or scan handles should they be damaged or stop working.

<b>ADD</b> SVCACC-MOB5	AddOn, Edge Service, Accessory Service , Mobility, <b>5 Year</b> . Service covers docks, charger cradles, scan handles
------------------------	--

#### Add-On Battery Replacement Service

Provides replacement batteries every 18 months after purchase.

<b>ADD</b> SVCBATTERY-MOB5	AddOn, Edge Service, Battery Service, Mobility, <b>5 Year</b> , 2 Replacement Battery over life of contract
----------------------------	---

#### Add-On Device Replacement Service

Replacement devices should a device be damaged beyond repair.

<b>ADD</b> SVCREPLACE-MOB5	AddOn, Edge Service, Device Replacement, Mobility, <b>5 Year</b>
----------------------------	--

#### Add-On Image Management Service

Ensures that when a device returns from being repaired, it has all the proper applications loaded back on the device.

<b>ADD</b> SVCIMAGEMGMT-MOB5	AddOn, Edge Service, Image Service, Mobility, <b>5 Year</b>
------------------------------	---

#### Add-On Spare Management Service

Manages every aspect of your spare pool.

<b>ADD</b> SVCSPAREMGMT-MOB5	AddOn, Edge Service, Advanced Exchange, Mobility, <b>5 Year</b> . Customer owned spare pool, Minimum Purchase required, contact your local Honeywell Service Representative for more information.
------------------------------	---

#### Add-On Sentinel Extended Service

Security patches and minor enhancements to legacy Android operating systems, typically added after year 3.

<b>ADD</b> SVCSENTINEL-MOB1	Sentinel Service, <b>1 Year</b> Android Support Contract
-----------------------------	--

<b>ADD</b> SVCSENTINEL-MOB2	Sentinel Service, <b>2 Year</b> Android Support Contract
-----------------------------	--

### Platinum Repair Services – 5 Year

The Edge Services Platinum Support contract is the only total support contract in the industry today offering 2-Day Depot Repairs or Spare Pool Management with 5-year contract, that includes:

#### Service Overview

- Repair or replacement of damaged components
- SVCREPLACE-MOB5 - Replacement devices should a device be damaged beyond repair
- SVCACC-MOB5 - Accessory replacement service
- SVCBATTERY-MOB5 - Battery replacement service
- PPSW-OPINTEL-PMP60 - Operational Intelligence Performance Professional licenses
- SVCSPAREMGMT-MOB5 - Spare pool management (optional, minimum quantity required)
- Telephone-based technical support
- Sentinel Extended Service that protects customers for future security updates on Android. The 5 year Sentinel coverage provides extended Android updates in years 4 and 5.

PART NUMBER	DESCRIPTION
SVCCT40-SP5N	CT40 / CT40 XP, Edge Service, PLATINUM, 2 Day Turnaround, 5 Year, New Contract

#### OPERATIONAL INTELLIGENCE SETUP MUST BE ORDERED WITH PLATINUM EDGE SERVICE CONTRACT

PPPS-OIPLI-SETUP	OpIntel Free Platinum Installation Basic & Professional
------------------	---



# HONEYWELL REPAIR SERVICES

## CT40 / CT40 XP – Repair Services Coverage

For Best-In-Class Service

CT40 / CT40 XP



Warranty Cover Against Product Defect

**BASIC Service**

Gold Coverage:

- Accidental Damage
- Wear & Tear

Includes Replacement of:

- Handstrap
- Screen Protector



Flexible GOLD Add-Ons ordered separately

- SVCACC-MOB3 Accessories
- SVCBATTERY-MOB3 Batteries
- SVCREPLACE-MOB3 Device Replacement
- SVCIMAGEMGMT-MOB3 Image Service
- SVCSPAREMGMT-MOB3 Advanced Exchange

**GOLD Service**

Platinum Coverage

- Battery Replacement
- Coverage for Docks/ Chargers
- Sentinel Extended Service for Android Security Updates

- Accidental Damage
- Device Replacement
- Wear & Tear



Pistol Grip



Battery  
(3 Year – 1 replacement battery per CT40)  
(5 Year – 2 replacement batteries per CT40)



Vehicle Dock



Docks



Car Chargers



Dock Power Supplies

**PLATINUM Service**

PART NUMBER	DESCRIPTION
SVCCT40-EXW2	CT40 / CT40 XP, BASIC, 10-15 Day Turnaround, 2 Years (1 Year Factory Warranty + 1 Year Extended)
SVCCT40-SG3N	CT40 / CT40 XP, Edge Service, GOLD Maintenance Contract, 5 Day Turnaround, 3 Year, New Contract
<b>ADD</b> SVCACC-MOB3	AddOn, Edge Service, Accessory Service , Mobility, 3 Year. Service covers docks, charger cradles, scan handles and car adapter
<b>ADD</b> SVCBATTERY-MOB3	AddOn, Edge Service, Battery Service, Mobility, 3 Year, 1 Replacement Battery over life of contract
<b>ADD</b> SVCREPLACE-MOB3	AddOn, Edge Service, Device Replacement, Mobility, 3 Year
<b>ADD</b> SVCIMAGEMGMT-MOB3	AddOn, Edge Service, Image Service, Mobility, 3 Year
<b>ADD</b> SVCSPAREMGMT-MOB3	AddOn, Edge Service, Advanced Exchange, Mobility, 3 Year. Customer owned spare pool, Minimum Purchase required.
SVCCT40-SP3N	CT40 / CT40 XP, Edge Service, PLATINUM, 2 Day Turnaround, 3 Year, New Contract



# CT40 / CT40 XP SOFTWARE

## Device Client Pack

Device Client Pack (DCP) includes first year maintenance. Add additional years of software maintenance for the applications below.

### Device Client Pack



Launcher - gives the customer total control over which apps can be run on the device.



Enterprise Browser provides corporations the ability to run standard web applications from a controlled environment.

PART NUMBER	DESCRIPTION
DCP-001	Device Client Pack License (Launcher & Enterprise Browser)
DCP-SFT1	Device Client Pack - 1 Year Maintenance (Launcher, Enterprise Browser)
DCP-SFT3	Device Client Pack - 3 Year Maintenance (Launcher, Enterprise Browser)

### Order Separately



Terminal Emulator - Full featured SmartTE allows legacy green screen apps to be transformed to the look and feel of native apps. These clients are single session Honeywell TE Licensing. They can also utilize traditional single or multi-session StayLinked Licenses.

PART NUMBER	DESCRIPTION
SMARTTE-001	SMARTTE - SINGLE PATH W-1 Year Maintenance
SMARTTE-SFT3	SMARTTE - 3 Year Software Maintenance
SMARTTE-SFT5	SMARTTE - 5 Year Software Maintenance

# CT40 / CT40 XP SCANNING

## Scan Handle Side by Side Comparison

Use for Scan intensive applications.



	PART NUMBER	DESCRIPTION
1	CT40-SH-DC	CT40 Scan Handle
2	CT40-SH-PB	Kit, CT40 scan handle includes TPU boot (CT40-PB-XP), compatible with CT40 and CT40 XP
3	CT40-SH-CC	CT40 Scan Handle Uncover Camera



# CT40 / CT40 XP SCANNING

## Option 1 - Scan Handle

Use for Scan intensive applications.



CT40 with Scan Handle Installed on Home Base

PART NUMBER	DESCRIPTION
1	<p>CT40 Scan Handle Compatible for use with Home Base and Charge Base without removal.</p> <p>CT40-SH-DC</p>
	<p>CT40-HB-0 / CT40-HB-UVN-0 Home Base</p> <p>CT40-EB-0 / CT40-EB-UVN-0 Ethernet Home Base</p> <p>CT40-DB-0 / CT40-DB-UVN-0 Display Base</p> <p>CT40-CB-CNV-0 / CT40-CB-UVN-0 Quad Charge Base</p> <p>CT40-NB-CNV-0 / CT40-NB-UVN-0 Quad Net Base</p> <p>Not Compatible with the Protective Boot Bases</p> <p>CT40-HB-UVB-0 Protective Boot Home Base</p> <p>CT40-EB-UVB-0 Protective Boot Ethernet Home Base</p> <p>CT40-DB-UVB-0 Protective Boot Display Base</p> <p>CT40-CB-PB-0 Protective Boot Quad Charge Base</p> <p>CT40-NB-PB-0 Protective Boot Quad Net Base</p> <p>CT40-CB-UVB-0 Protective Boot Quad Charge Base</p> <p>CT40-NB-UVB-0 Protective Boot Quad Net Base</p>

# CT40 / CT40 XP SCANNING

## Option 2 - Scan Handle with Protective Boot

Use for Scan intensive applications with additional protection of the protective boot.  
 This scan handle is ONLY compatible with protective boot charging docks.



Insert CT40 into Protective Boot

Insert Scan Handle into Protective Boot

PART NUMBER	DESCRIPTION
1 CT40-SH-PB	Kit, CT40 scan handle and includes TPU boot (CT40-PB-XP) compatible with CT40 and CT40 XP Compatible for use with Protective Boot Home Base and Charge Base without removal.
	CT40-HB-UVB-0 Protective Boot Home Base
	CT40-EB-UVB-0 Protective Boot Ethernet Home Base
	CT40-DB-UVB-0 Protective Boot Display Base
	CT40-CB-PB-0 Protective Boot Quad Charge Base
	CT40-NB-PB-0 Protective Boot Quad Net Base

Not Compatible with the Non-Protective Boot Bases

CT40-HB-0 / CT40-HB-UVN-0 Home Base  
 CT40-EB-0 / CT40-EB-UVN-0 Ethernet Home Base  
 CT40-DB-0 / CT40-DB-UVN-0 Display Base

CT40-CB-UVB-0 Protective Boot Quad Charge Base  
 CT40-NB-UVB-0 Protective Boot Quad Net Base

CT40-CB-CNV-0 / CT40-CB-UVN-0 Quad Charge Base  
 CT40-NB-CNV-0 / CT40-NB-UVN-0 Quad Net Base



# CT40 / CT40 XP SCANNING

## Option 3 - Scan Handle for use with Camera

Use for Scan intensive applications as well as unimpeded access to the Camera.



CT40 with Scan Handle Installed on Home Base

PART NUMBER	DESCRIPTION
1	<p>CT40-SH-CC CT40 Scan Handle Uncover Camera Compatible for use with Home Base and Charge Base without removal.</p> <p>CT40-HB-0 / CT40-HB-UVN-0 Home Base</p> <p>CT40-EB-0 / CT40-EB-UVN-0 Ethernet Home Base</p> <p>CT40-DB-0 / CT40-DB-UVN-0 Display Base</p> <p>CT40-CB-CNV-0 / CT40-CB-UVN-0 Quad Charge Base</p> <p>CT40-NB-CNV-0 / CT40-NB-UVN-0 Quad Net Base</p> <p>Not Compatible with the Protective Boot Bases</p> <p>CT40-HB-UVB-0 Protective Boot Home Base</p> <p>CT40-EB-UVB-0 Protective Boot Ethernet Home Base</p> <p>CT40-DB-UVB-0 Protective Boot Display Base</p> <p>CT40-CB-PB-0 Protective Boot Quad Charge Base</p> <p>CT40-NB-PB-0 Protective Boot Quad Net Base</p> <p>CT40-CB-UVB-0 Protective Boot Quad Charge Base</p> <p>CT40-NB-UVB-0 Protective Boot Quad Net Base</p>

# CT40 / CT40 XP DESKTOP COMMUNICATIONS

## Option 1 – Portable – Non-Booted

USB Communication to PC/ Mac OR Snap-On Charging.



## Option 2 – Portable – Non-Booted or Booted

USB Communication to PC/ Mac OR Snap-On Charging.



**PART NUMBER      DESCRIPTION**

1	CT40-SN-USB-0	Snap-on cup with Standard Type A connector.
2	50136024-001	KIT,5V/2A PS,5 PLUGS PACKED, ROW Includes US,UK,AU,EU,IN adapters

**PART NUMBER      DESCRIPTION**

1	CT40-SN-CNV	Snap on adaptor for charging CT40 with or without boot with a convertible adaptor. Provides tethered USB client connectivity. Compatible with hand strap, battery pack, and scan handle. Charges mobile computer battery in four hours or less. Kit includes snap-on adapter with convertible adaptor. Optional 50136024-001 (5 V/2 A) USB power wall adapter sold separately.
---	-------------	--



# CT40 XP COMMUNICATIONS

## Option 3 – CT40 XP USB Type C On-The-Go (OTG) Desktop

USB C Communication to PC/ Mac OR Charging.  
Only Compatible with CT40 XP.

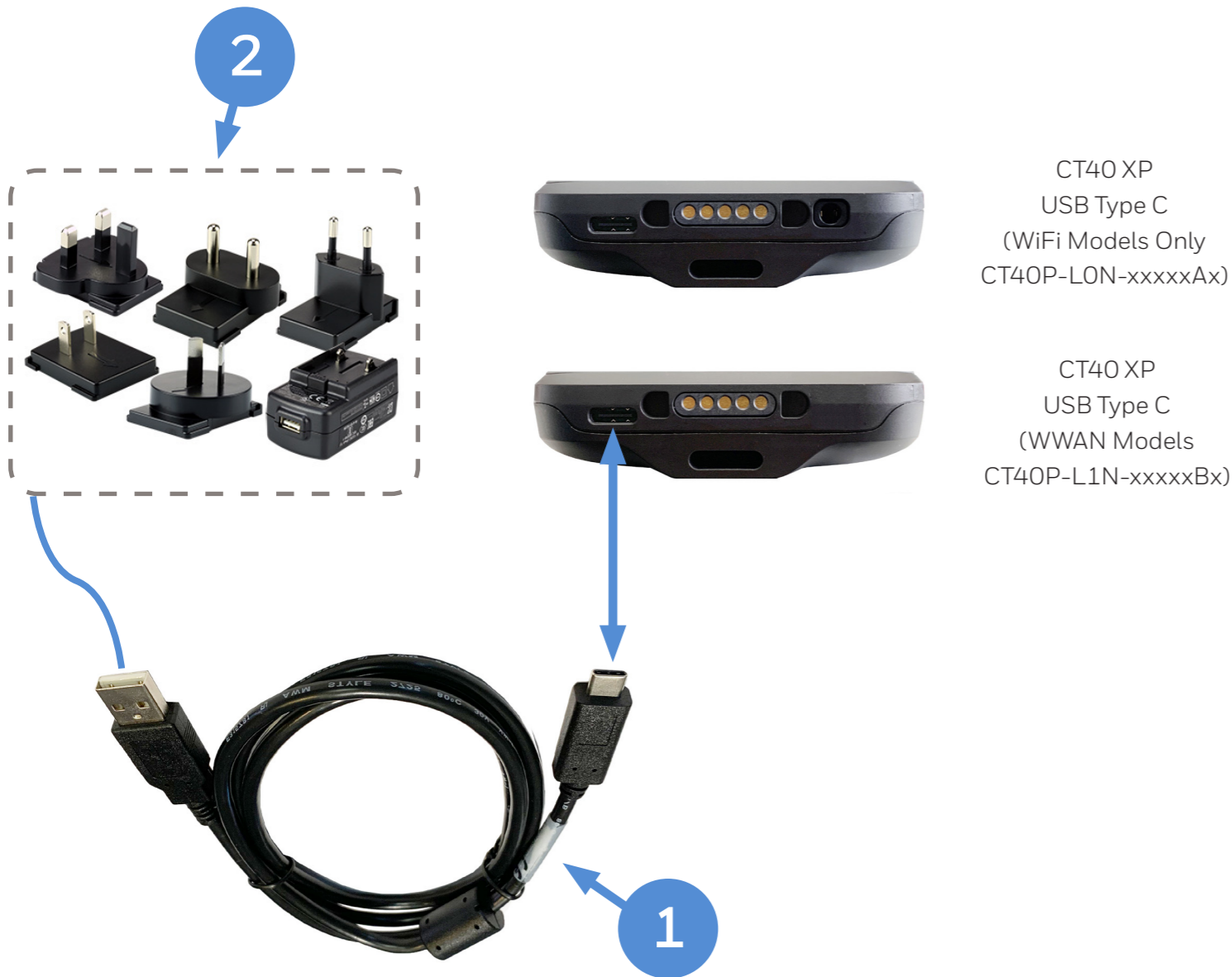

## Option 4 – CT40 XP USB Type C On-The-Go (OTG) Vehicle

USB C Communication to Vehicle OR Charging.  
Only Compatible with CT40 XP.



**PART NUMBER**      **DESCRIPTION**

1	CBL-500-120-S00-05	USB type A to type C, 1.2 m (3.9 ft)
2	50136024-001	KIT,5V/2A PS,5 PLUGS PACKED, ROW Includes US,UK,AU,EU,IN adapters

**PART NUMBER**      **DESCRIPTION**

1	CBL-500-120-S00-05	USB type A to type C, 1.2 m (3.9 ft)
2	CT40-CIGR-0	Accessory Cigarette Lighter Power Adapter with USB Socket (Provides 12 V/24 V cigarette lighter port to USB type-A power adapter for snap-on use in a vehicle)

# CT40 / CT40 XP DESKTOP COMMUNICATIONS

## Option 5 – Fixed

USB and optional Ethernet Communication & Single Battery Charger.

Not Compatible with CT40-RB-00 Rubber Boot or CT40-PB-00 / CT40-PB-XP Protective Boot



**PART NUMBER      DESCRIPTION**

<b>1</b>	CT40-HB-0	HomeBase - Kit includes Dock & Power Supply, must order Power Cord separately
<b>OR</b>	CT40-EB-0	eHomeBase – Ethernet Kit includes Dock & Power Supply, must order Power Cord separately
<b>2</b>	321-576-004	Cable Assembly - USB Type A to Type B
<b>3</b>	**	AC Power Cord – See Page 38 for Country Specific Power Cords

## Option 6 – Fixed with Universal Cup

USB and optional Ethernet Communication & Single Battery Charger.

Not Compatible with CT40-RB-00 Rubber Boot



**PART NUMBER      DESCRIPTION**

<b>1A</b>	CT40-HB-UVN-0	<b>Non-Booted</b> HomeBase - Kit includes (CT40-UCP-N), Dock & Power Supply, No Power Cord
<b>OR</b>	CT40-EB-UVN-0	<b>Non-Booted</b> eHomeBase – <b>Ethernet</b> Kit includes (CT40-UCP-N), Dock & Power Supply, No Power Cord
<b>1B</b>	CT40-HB-UVB-0	<b>Booted</b> HomeBase - Kit includes (CT40-UCP-B), Dock & Power Supply, No Power Cord
<b>OR</b>	CT40-EB-UVB-0	<b>Booted</b> eHomeBase – <b>Ethernet</b> Kit includes (CT40-UCP-B), Dock & Power Supply, No Power Cord
<b>2</b>	321-576-004	Cable Assembly - USB Type A to Type B
<b>3</b>	**	AC Power Cord – See Page 38 for Country Specific Power Cords



# CT40 / CT40 XP DESKTOP COMMUNICATIONS

## Option 7 – Display Base

Connect USB peripherals (keyboard, mouse) and External Monitor via HDMI.



PART NUMBER	DESCRIPTION
1 CT40-DB-0	Display Dock - Kit includes Dock & Power Supply, must order Power Cord separately
2 **	AC Power Cord – See Page 38 for Country Specific Power Cords

## Option 8 – Display Base with Universal Cup

Connect USB peripherals (keyboard, mouse) and External Monitor via HDMI.



PART NUMBER	DESCRIPTION
1A CT40-DB-UVN-0	<b>Non-Booted</b> Display Dock - Kit includes (CT40-UCP-N), Display Base & Power Supply, No Power Cord
1B CT40-DB-UVB-0	<b>Booted</b> Display Dock - Kit includes (CT40-UCP-B), Display Base & Power Supply, No Power Cord
2 **	AC Power Cord – See Page 38 for Country Specific Power Cords

# CT40 / CT40 XP VEHICLE INSTALL

## Option 1 – Portable/ Sub Contractor Install

Simple Vehicle Charging, portable between vehicles.

Compatible with CT40 and CT40 XP with or without CT40-PB-XP Protective Boot installed.



**PART NUMBER**      **DESCRIPTION**

1	CT40-SN-CNV	Snap on adaptor for charging CT40 with or without boot with a convertible adaptor. Provides tethered USB client connectivity. Compatible with hand strap, battery pack, and scan handle. Charges mobile computer battery in four hours or less. Kit includes snap-on adaptor with convertible adaptor.
2	CT40-CIGR-0	Accessory Cigarette Lighter Power Adapter with USB Socket (Provides 12 V/24 V cigarette lighter port to USB type-A power adapter for snap-on use in a vehicle)

## Option 2 – Portable/ Sub Contractor Install

Windscreen Suction Cup Mount, portable between vehicles.

Compatible with CT40 and CT40 XP with or without CT40-PB-XP Protective Boot installed.



Recommended Screws  
8#-32-UNC  
(Length = 0.5 inch)  
50143775-001 Pack 4 Screws

**PART NUMBER**      **DESCRIPTION**

1	CT40-VD-CNV	CT40 Booted or Non-Booted Vehicle Dock w/ hard wired 3-pin power cable
2	RAM-B-166-202U	Suction Cup Mount Kit
3	50138169-001	Cigarette Lighter Power Adapter Cable



# CT40 / CT40 XP VEHICLE INSTALL

## Option 3 - Fixed Vehicle Install with Direct Connection to Vehicle Battery

Best used when the vehicle input voltage varies, 10- 30V.

Compatible with CT40 and CT40 XP with or without CT40-PB-XP Protective Boot installed.



PART NUMBER	DESCRIPTION
1	CT40-VD-CNV CT40 Booted or Non-Booted Vehicle Dock w/ hard wired 3-pin power cable
2	203-802-001 Vehicle Dock Installation Kit (Power Option: For connection of Vehicle Dock directly to vehicle battery. Includes power cables and cable mounting hardware)
3	805-611-001 Mounting Kit, V-Dock RoHS

# CT40 / CT40 XP VEHICLE INSTALL

## Option 4 - Fixed Vehicle Install with Direct Connection to Vehicle Battery/ Fuse Block

Best used when the vehicle input voltage varies, 10- 30V.

Compatible with CT40 and CT40 XP with or without CT40-PB-XP Protective Boot installed.



	PART NUMBER	DESCRIPTION
<b>1</b>	CT40-VD-CNV	CT40 Booted or Non-Booted Vehicle Dock w/ hard wired 3-pin power cable
<b>2</b>	226-109-003	72" (182.88 cm) Fuse block Power Cable with spade lugs and 3-pin connector
<b>OR</b>	226-109-004	22" (55.8 cm) Fuse block Power Cable with spade lugs and 3-pin connector
<b>3</b>	805-611-001	Mounting Kit, V-Dock RoHS
<b>OPTIONAL</b>	203-803-001	Vehicle Dock Fuse Block Power Kit RoHS (Provides connection to vehicle fuse block). Requires Power Cable (226-109-003 or 226-109-004).



# CT40 / CT40 XP VEHICLE INSTALL

## Option 5 - Fixed Vehicle Install with Thor DC/DC Converter

Best used when the vehicle input voltage varies, 9-60V or 50-150V.  
 Compatible with CT40 and CT40 XP with or without CT40-PB-XP Protective Boot installed.



PART NUMBER	DESCRIPTION
1	CT40-VD-CNV CT40 Booted or Non-Booted Vehicle Dock w/ hard wired 3-pin power cable
2	9000311PWSPLY DC/DC Converter Kit, 9-60V DC, RoHS (Requires 226-109-003 Wiring Harness)
OR	9000313PWSPLY DC/DC Converter Kit, 50-150V DC RoHS (Requires 226-109-003 Wiring Harness)
	226-109-003 72" (182.88 cm) Fuse block Power Cable with spade lugs and 3-pin connector
3	805-611-001 Mounting Kit, V-Dock RoHS

# CT40 / CT40 XP VEHICLE INSTALL

## CT40 Vehicle Dock 360 degree view



Front View

Front View  
CT40 Non-Booted

Front View  
CT40 Booted

Rear View

Side View

Recommended Screws  
8#-32-UNC  
(Length = 0.5 inch)



# CT40 / CT40 XP CHARGING AND COMMUNICATION

## Option 1 - Non-Booted Quad Charger

Chargebase – Quad Dock Charge Only

Netbase – Quad Dock with Ethernet

Not Compatible with CT40-RB-00 Rubber Boot or CT40-PB-00 / CT40-PB-XP Protective Boot



## Option 2 - Non-Booted Quad Charger with Universal Cup

Chargebase – Quad Dock Charge Only

Netbase – Quad Dock with Ethernet

Not Compatible with CT40-RB-00 Rubber Boot or CT40-PB-00 / CT40-PB-XP Protective Boot



Kit Includes:  
4 x CT40-UCP-N  
CT40 Cup for Non-Booted

PART NUMBER	DESCRIPTION
1	CT40-CB-CNV-0 Chargebase - Kit includes Dock and Power Supply
OR	CT40-NB-CNV-0 Netbase - For Ethernet comms, Kit includes Dock and Power Supply
2	** AC Power Cord – See Page 38 for Country Specific Power Cords

PART NUMBER	DESCRIPTION
1	CT40-CB-UVN-0 <b>Non-Booted</b> Chargebase - Kit includes Dock and Power Supply
OR	CT40-NB-UVN-0 <b>Non-Booted</b> Netbase - For Ethernet comms, Kit includes Dock and Power Supply
2	** AC Power Cord – See Page 38 for Country Specific Power Cords

# CT40 / CT40 XP CHARGING AND COMMUNICATION

## Option 3 – Booted Quad Charger

Chargebase – Quad Dock Charge Only  
 Netbase – Quad Dock with Ethernet  
 Compatible with CT40-PB-00 / CT40-PB-XP Protective Boot

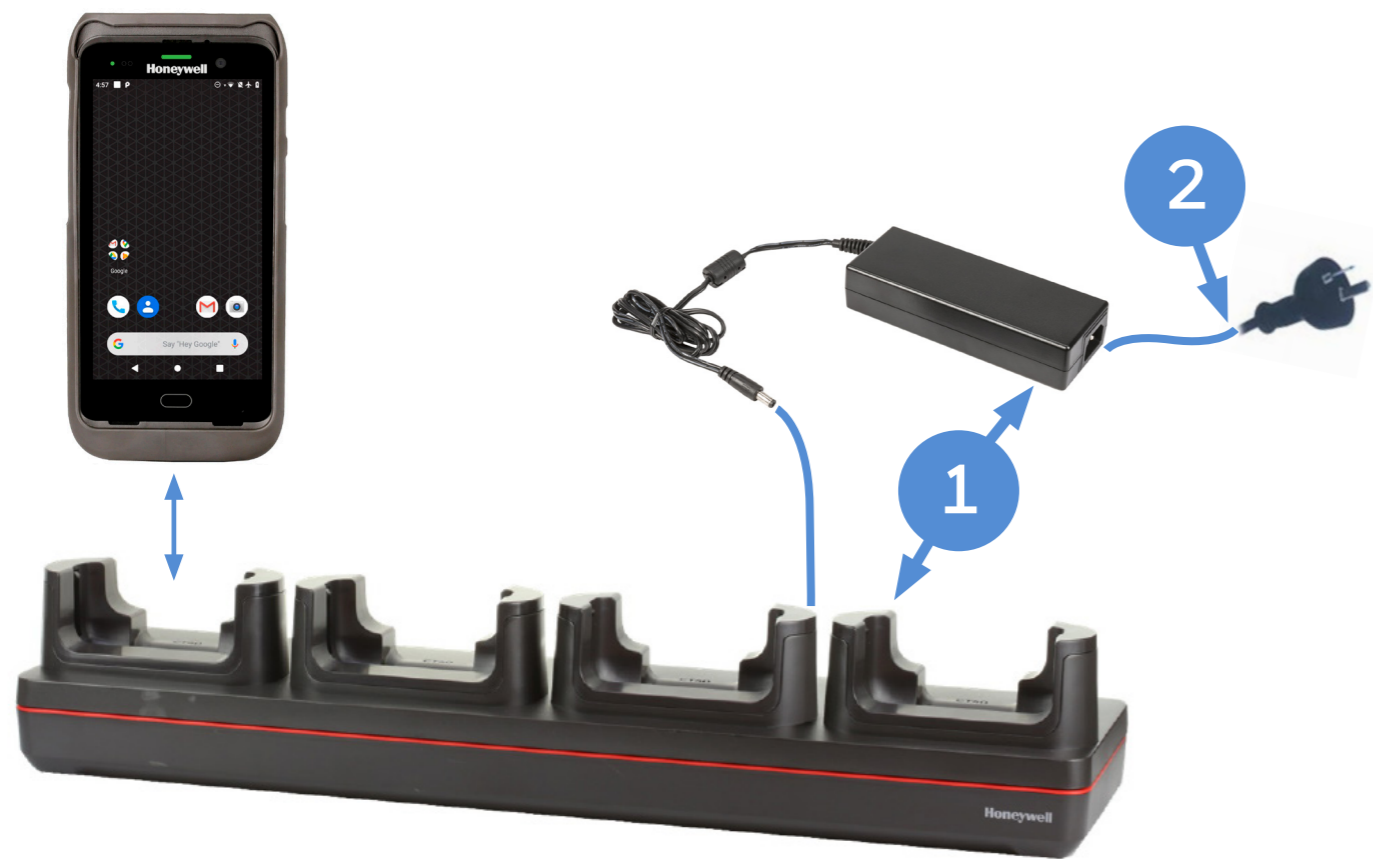

## Option 4 – Booted Quad Charger with Universal Cup

Chargebase – Quad Dock Charge Only  
 Netbase – Quad Dock with Ethernet  
 Compatible with CT40-PB-00 / CT40-PB-XP Protective Boot



Kit Includes:  
 4 x CT40-UCP-B  
 CT40 Cup for Booted

PART NUMBER	DESCRIPTION
1 CT40-CB-PB-0	Booted Chargebase - Kit includes Dock and Power Supply
OR CT40-NB-PB-0	Booted Netbase - For Ethernet comms, Kit includes Dock and Power Supply
2 **	AC Power Cord – See Page 38 for Country Specific Power Cords

PART NUMBER	DESCRIPTION
1 CT40-CB-UVB-0	Booted Chargebase - Kit includes Dock and Power Supply
OR CT40-NB-UVB-0	Booted Netbase - For Ethernet comms, Kit includes Dock and Power Supply
2 **	AC Power Cord – See Page 38 for Country Specific Power Cords



# CT40 / CT40 XP CHARGING AND COMMUNICATION

## Option 5 - Quad Battery Charger

Charge up to 4 batteries simultaneously

Supports Batteries: 318-055-010 - Battery, Standard, CT40 (4090mAh)  
 318-055-014 - Battery, Standard, CT40 (4090mAh)  
 318-055-015 - Battery, Standard, CT40 (4040mAh)  
 318-055-017 - Battery, Standard, CT40 Healthcare (4020mAh)  
 318-055-D67 - Battery, Standard, CT40 DRH (4020mAh)

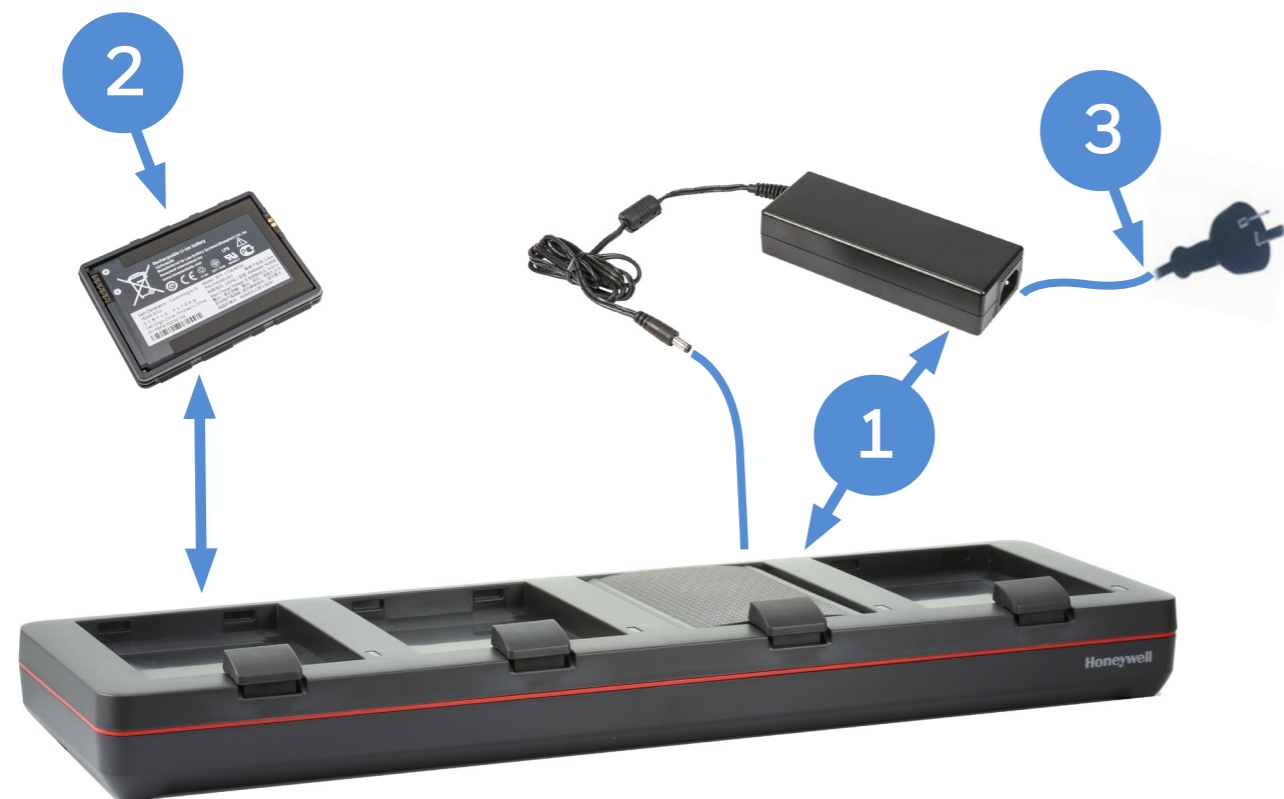

	PART NUMBER	DESCRIPTION
1	CT40-QBC-0	Quad Battery Charger - Kit includes Dock and Power Supply
2	318-055-015	CT40 Gen 2 Battery Pack, 4040mAh
OR	318-055-017	CT40 HC battery Pack, 3.85V, 4020mAh, White cover, Healthcare
3	**	AC Power Cord - See Page 38 for Country Specific Power Cords

# CT40 / CT40 XP RFID

## IH21 RFID Reader for CT40 / CT40 XP

Connect the IH21 to the CT40 via Bluetooth.



IH21 Charging Cradle

	PART NUMBER	REGION	DESCRIPTION
<b>1</b>	IH21A0020	AUS	IH21 Bluetooth RFID Reader with e-Pop-Loq, UHF Antenna, Trigger Handle, Battery, Battery Cover, no imager, red and black. AU
<b>OR</b>	IH21A0014	FCC	IH21 Bluetooth RFID Reader with e-Pop-Loq, UHF Antenna, Trigger Handle, Battery, Battery Cover, no imager, red and black.FCC
<b>OR</b>	IH21A0002	ETSI	IH21 Bluetooth RFID Reader with e-Pop-Loq, UHF Antenna, Trigger Handle, Battery, Battery Cover, no imager, red and black.ETSI
<b>2</b>	IH21-EPL-CT40		Cover,ePop-Loq CT40, IH21
<b>3</b>	IH21-CB-1		IH21 Docking Cradle with World traveler PSU and Mini USB Lead, red and black
<b>OPTIONAL</b>	IH21-QBC-1		4-Slot Battery Charger. Order power supply 851-812-001 & Power Cord separately
<b>OPTIONAL</b>	851-812-001		AC ADAPTER,12V/60W,2.5X5.5MM,LEVEL VI. Order AC Power Cord – See Page 38 for Country Specific Power Cords
<b>OPTIONAL</b>	318-060-001		Spare Battery for IH21 RFID reader



# CT40 HEALTHCARE CHARGING AND COMMUNICATION

## Option 1 - Non-Booted Quad Charger with Universal Cup

Chargebase – Quad Dock Charge Only

Netbase – Quad Dock with Ethernet

Not Compatible with CT40-RB-00 Rubber Boot or CT40-PB-00 / CT40-PB-XP Protective Boot

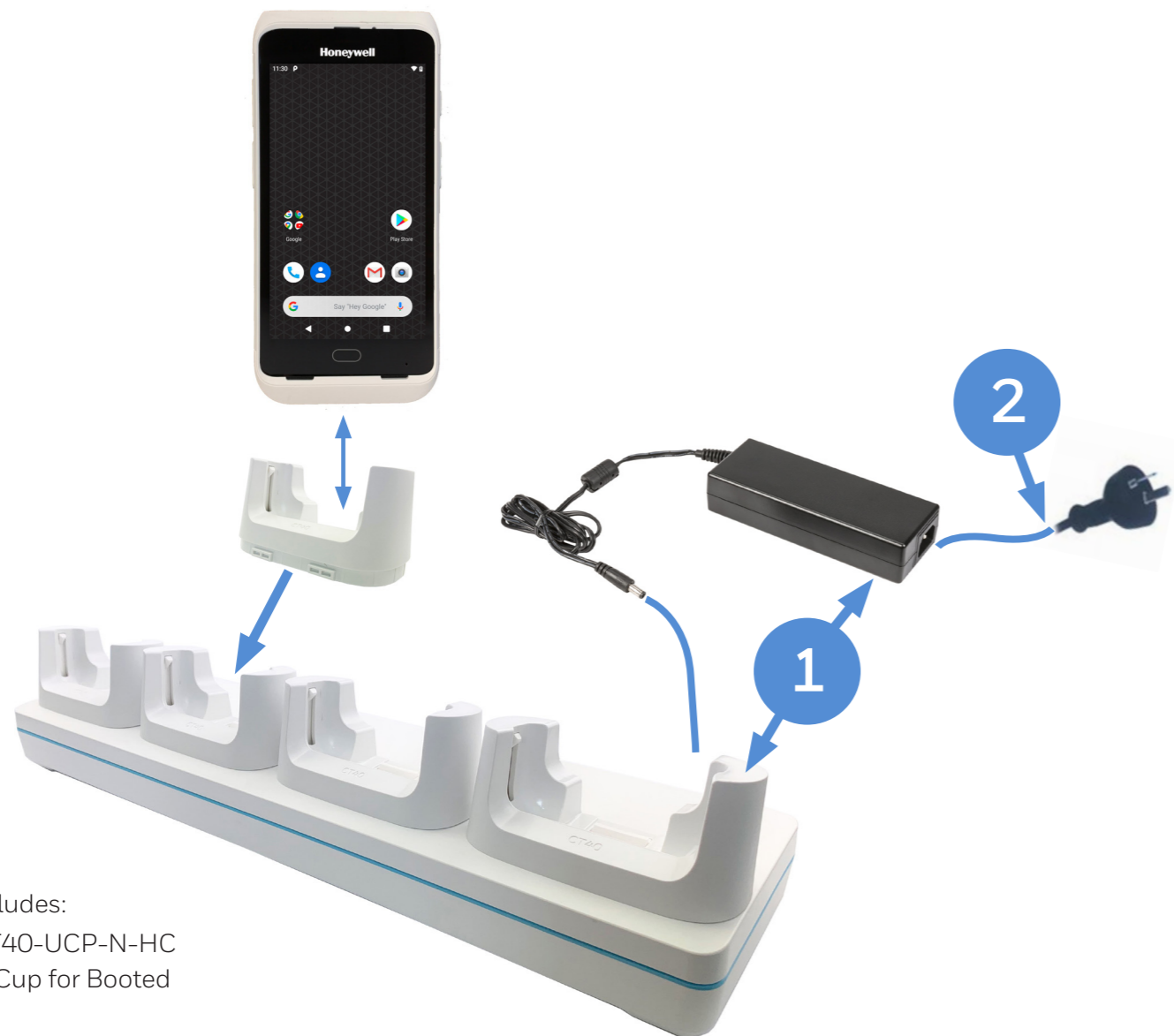

Kit Includes:  
4 x CT40-UCP-N-HC  
CT40 Cup for Booted

## Option 2 - Booted Quad Charger with Universal Cup

Chargebase – Quad Dock Charge Only

Netbase – Quad Dock with Ethernet

Compatible with CT40-PB-00 / CT40-PB-XP Protective Boot



Kit Includes:  
4 x CT40-UCP-B-HC  
CT40 Cup for Booted

	PART NUMBER	DESCRIPTION
1	CT40-CB-UVN-HCO	<b>Non-Booted</b> Chargebase with disinfectant ready housing. For recharging upto 4 computers without protective boot. Kit includes Dock, Power Supply, must order Power Cord separately.
OR	CT40-NB-UVN-HCO	<b>Non-Booted</b> Net base with disinfectant ready housing, for Ethernet comms and recharging upto 4 computers without protective boot. Kit includes Dock and Power Supply, must order Power Cord separately.
2	**	AC Power Cord – See Page 38 for Country Specific Power Cords

	PART NUMBER	DESCRIPTION
1	CT40-CB-UVB-HCO	<b>Booted</b> Chargebase with disinfectant ready housing. For recharging upto 4 computers with protective boot. Kit includes Dock, Power Supply, must order Power Cord separately.
OR	CT40-NB-UVB-HCO	<b>Booted</b> Net base with disinfectant ready housing, for Ethernet comms and recharging upto 4 computers with protective boot. Kit includes Dock and Power Supply, must order Power Cord separately.
2	**	AC Power Cord – See Page 38 for Country Specific Power Cords

# CT40 HEALTHCARE CHARGING AND COMMUNICATION

## Option 3 - CT40 HC Display Base with Universal Cup

Connect USB peripherals (keyboard, mouse) and External Monitor via HDMI.

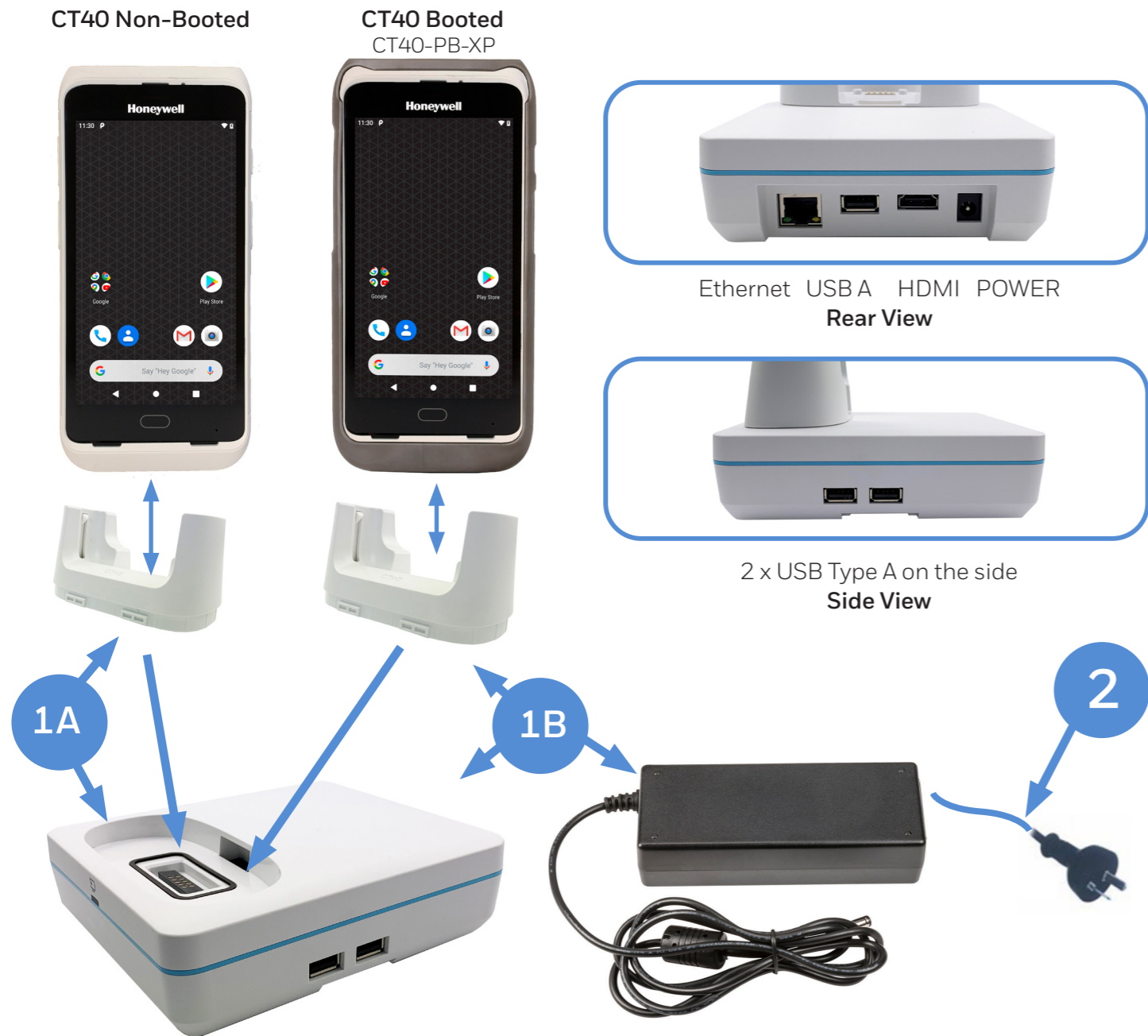

	PART NUMBER	DESCRIPTION
1A	CT40-DB-UVN-HCO	<b>Non-Booted</b> Display Dock with disinfectant ready housing - Kit includes (CT40-UCP-N-HC), Display Base & Power Supply, No Power Cord
1B	CT40-DB-UVB-HCO	<b>Booted</b> Display Dock with disinfectant ready housing - Kit includes (CT40-UCP-B-HC), Display Base & Power Supply, No Power Cord
2	**	AC Power Cord – See Page 38 for Country Specific Power Cords



# CT40 / CT40 XP PROTECTIVE BOOT

## Option 1 - Rubber Boot

Use for added protection of the CT40.

Not Compatible with Scan Handles / Home Base / Charge Base Docks / Vehicle Dock.



1

PART NUMBER	DESCRIPTION
1 CT40-RB-00	CT40 Rubber Boot

## Option 2 - Dockable Protective Boot

Use when protective boot is required with or without scan handle and dockable.



1

CT40 XP  
CT40-PB-XP  
Side View

PART NUMBER	DESCRIPTION
1 CT40-PB-00	CT40 TPU boot (Not Compatible with CT40 XP)
OR CT40-PB-XP	CT40 protective boot to charge CT40XP & general CT40 configurations. A boot with the ability to expose the CT40XP 's Push To Talk (PTT) button.

# CT40 / CT40 XP HEADSET

## CT40 Push To Talk (PTT) and VoIP Headset

PTT and VoIP ready to support In-Store Communication with leading 3rd party applications.

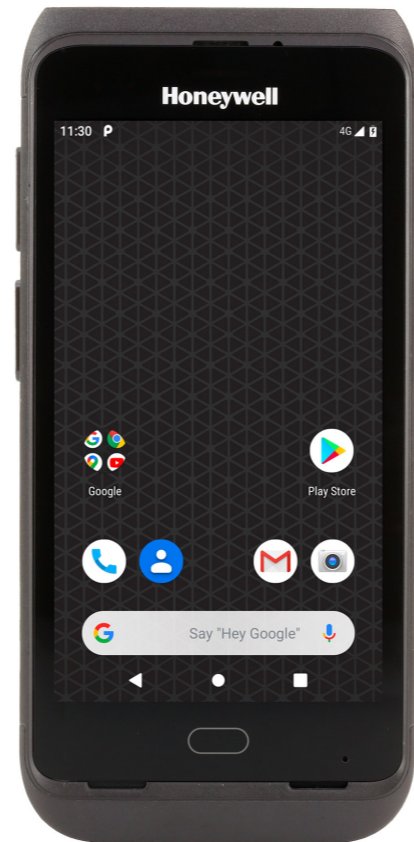
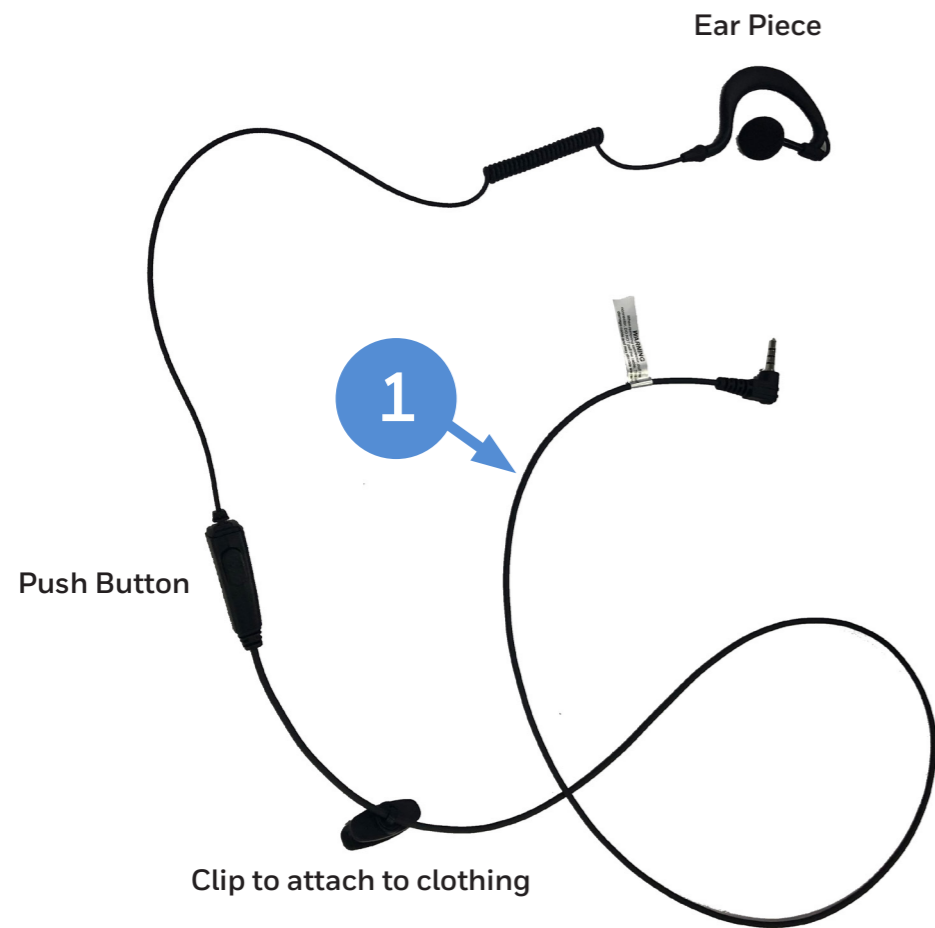

3.5mm Audio Jack  
(WiFi Models Only  
CT40-LON-xxxxxAx or CT40P-LON-xxxxxAx)

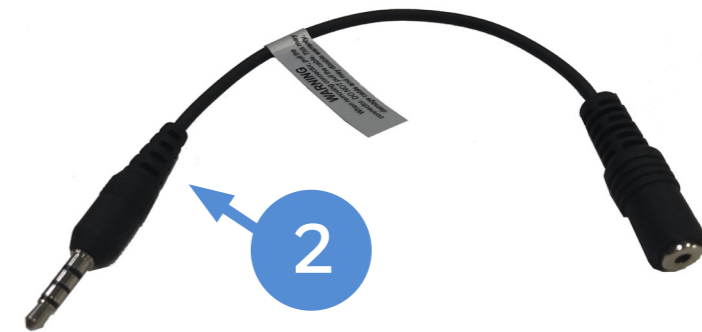

2.5mm Adapter Cable

	PART NUMBER	DESCRIPTION
1	CT40-HDST-35MM	CT40 Headset with PTT, 3.5mm audio jack
OPTIONAL 2	CT40-CVT-25MM	3.5mm plug to 2.5mm Socket Adaptor Cable (for attaching 3rd party 2.5mm headsets)



# CT40 / CT40 XP WEARABLE

## CT40 with Tethered Ring Scanner

Convert the CT40 into a Wearable Computer with Tethered Ring Scanner.





# CT40 / CT40 XP WEARABLE WITH TETHERED RING SCANNER

## Option 1 - CT40 Wearable with D75e Arm Band

Re-use existing D75e Arm Band (HWC-ARM BAND).



## Option 2 - CT40 Wearable - Arm Band Wrist Pad

Arm Band with wrist pad.



PART NUMBER	DESCRIPTION
CT40-WS-KIT	CT40 WEARABLE SET, including Holder, tethered ring scanner and arm band
CT40-WS-PB	CT40 Holder with tethered ring scanner
HWC-ARM BAND	Arm Band, Wearable Computer

PART NUMBER	DESCRIPTION
CT40-WS-00	CT40 WEARABLE SET, including Holder, tethered ring scanner and arm band.
CT40-WS-PB	CT40 Holder with tethered ring scanner
CT40-WS-AB	Arm Band Wrist Band

See next page for exploded view of individual components.



# CT40 / CT40 XP WEARABLE WITH TETHERED RING SCANNER

## Option 1 - CT40 Wearable with D75e Arm Band

Re-use existing D75e Arm Band (HWC-ARM BAND).



Large Ring Strap  
(One included with CT40-WS-KIT)

Spares - 8600503SOFTSTRAP  
20 pack ring finger straps  
small soft rubber straps with snap-on mount.

Small Ring Strap  
(One included with CT40-WS-KIT)

Spares - 8600504SOFTSTRAP  
20 pack ring finger straps  
large soft rubber straps with snap-on mount.

PART NUMBER	DESCRIPTION
1	CT40-PB-XP CT40 protective boot to charge CT40XP & general CT40 configurations.
2	CT40-WS-KIT CT40 WEARABLE SET, including Holder, tethered ring scanner and arm band. CT40-WS-PB      CT40 Holder with tethered ring scanner HWC-ARM BAND      Arm Band, Wearable Computer

Honeywell Repair Services

SVCWRSCT40-SG3N CT40 Wearable, Edge Service, Gold Maintenance Contract, 3 Year, New Contract

## Option 2 - CT40 Wearable - Arm Band Wrist Pad

Arm Band with wrist pad.



Large Ring Strap  
(One included with CT40-WS-00)

Spares - 8600503SOFTSTRAP  
20 pack ring finger straps  
small soft rubber straps with snap-on mount.

Small Ring Strap  
(One included with CT40-WS-KIT)

Spares - 8600504SOFTSTRAP  
20 pack ring finger straps  
large soft rubber straps with snap-on mount.

PART NUMBER	DESCRIPTION
1	CT40-PB-XP CT40 protective boot to charge CT40XP & general CT40 configurations.
2	CT40-WS-00 CT40 WEARABLE SET, including Holder, tethered ring scanner and arm band. CT40-WS-PB      CT40 Holder with tethered ring scanner CT40-WS-AB      Arm Band Wrist Band

Honeywell Repair Services

SVCWRSCT40-SG3N CT40 Wearable, Edge Service, Gold Maintenance Contract, 3 Year, New Contract

# MISCELLANEOUS

## Optional Parts

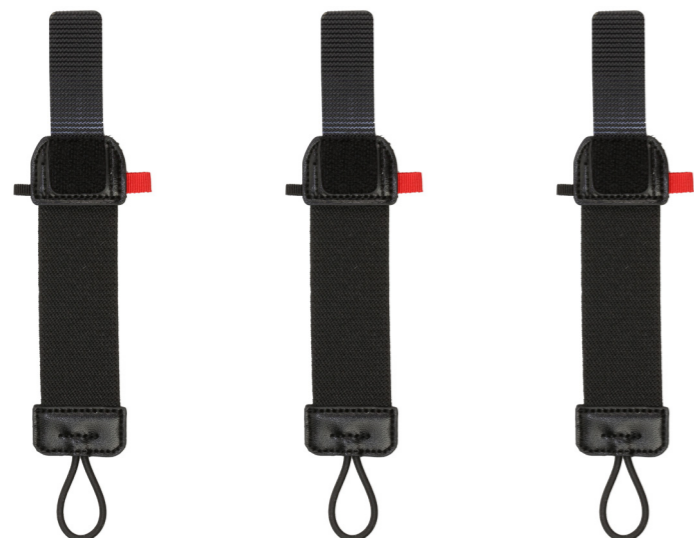

PART NUMBER	DESCRIPTION
CT40-HS-3PK	CT40 HAND STRAP, pack of 3

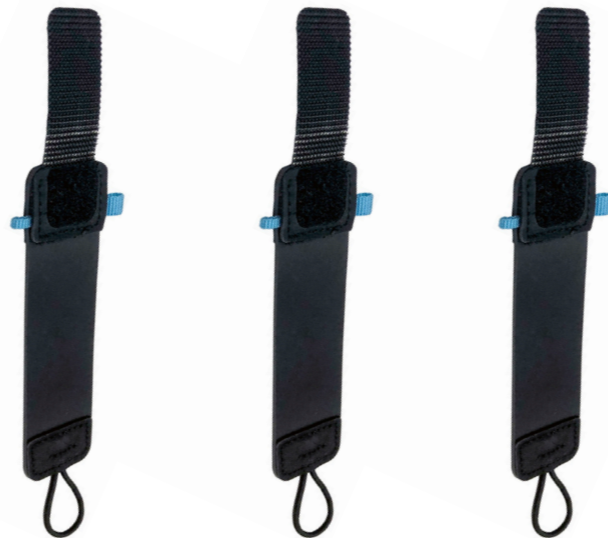

PART NUMBER	DESCRIPTION
CT40-HS-HC	CT40 Healthcare HAND STRAP, 3PCS / PACK



PART NUMBER	DESCRIPTION
50121666-001	Power Adapter,12V 3A, No Power Cord, Compatible with CT40 Homebase / eHomebase / Quad Battery Charger



PART NUMBER	DESCRIPTION
213-048-001	Pack of 5 CT40 / CT50 / CT60 replacement styluses.
8754-871600-20	Pack of 10 CT40 / CT50 / CT60 replacement styluses.



PART NUMBER	DESCRIPTION
CT40-SP-10PK	Contains 10 self-adhesive screen protectors



PART NUMBER	DESCRIPTION
50121667-001	Power Adapter,12V 7A, No Power Cord, CT40 Quad Chargebase/Quad Netbase



# MISCELLANEOUS

## Optional Parts



**PART NUMBER**    **DESCRIPTION**

CT40-UCP-N    CT40 **Non-Booted** universal cup, to be used for CT40 without protective boot

**PART NUMBER**    **DESCRIPTION**

CT40-UCP-B    CT40 **Booted** universal cup, to be used for CT40 with protective boot (CT40-PB-XP)



**PART NUMBER**    **DESCRIPTION**

CT40-UCP-N-HC    CT40 **Non-Booted** disinfectant ready housing universal cup, to be used for CT40 without protective boot

**PART NUMBER**    **DESCRIPTION**

CT40-UCP-B-HC    CT40 **Booted** disinfectant ready housing universal cup, to be used for CT40 with protective boot (CT40-PB-XP)

# MISCELLANEOUS

## Optional Parts



**PART NUMBER DESCRIPTION**

CT50-CC-12 CHARGING CABINET FOR CT40/CT50/CT60 with space to house 12 Computers and 12 Spare Batteries. Quad battery chargers (CT40-QBC-0) and Quad ChargeBase (CT40-CB-0)

**PART NUMBER DESCRIPTION**

CT40-QL-00 CT40 Quad Lock Case Mount CT40 to 3rd party RFID readers



**PART NUMBER DESCRIPTION**

825-237-001 POUCH, CT40/CT50/CT60/CT60 XP

**PART NUMBER DESCRIPTION**

825-238-001 CT40/CT50/CT60/CT60 XP Holster



# MISCELLANEOUS

## Micro-SD Cards

Honeywell Recommended – ATP Industrial Grade Micro SD Cards

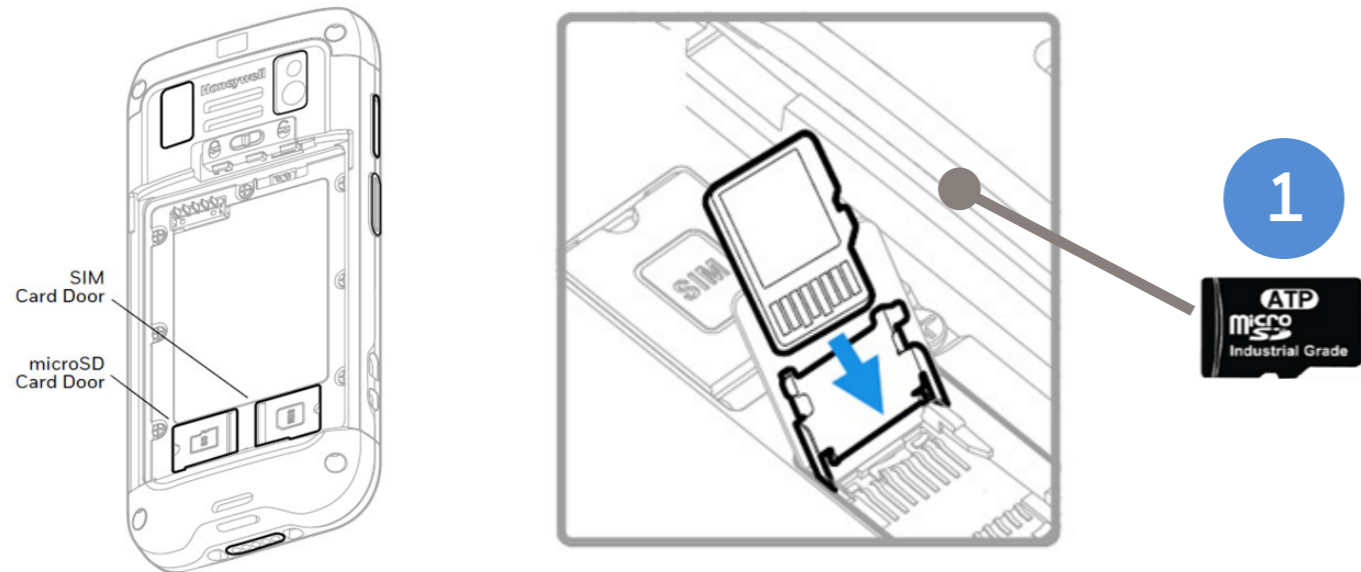

Why ATP Industrial Grade SD?

ATP's SIP (System-In-Packaging) manufacturing process encapsulates all exposed components and points of failure to ensure the products are fully waterproof, shockproof, and ESD (Electro-Static Discharge) proof. ATP Industrial Grade SD/SDHC Cards can withstand at least an operating/storage temperature range of at least -40 to 85 degrees Celsius. In addition to this temperature range, the cards are completely waterproof, dustproof, and ESD (Electro-Static Discharge) proof. All ATP Industrial Grade SD/SDHC cards are produced under a stringent RoHS and Green Package compliant manufacturing process to guarantee a consistent high level of build quality and performance. ATP Industrial SD cards deliver outstanding performance with read speed (seq) up to 18MB/sec and write speed (seq) up to 16MB/sec. All ATP Industrial Grade CF, SD, USB drives, and SSDs are constructed using best-in-class SLC(Single-Level Cell) components with enhanced Error Correction Code(ECC) functions and wear levelling algorithms. This results in MTBF ratings over 2 million hours and the highest write cycle lifetimes in the industry.

	PART NUMBER	DESCRIPTION
<b>1</b>	856-065-004	MICRO-SD CARD, <b>1GB</b> , AFIGUDI, ROHS
<b>OR</b>	856-065-005	MICRO-SD CARD, <b>2GB</b> , AFIGUDI, ROHS
<b>OR</b>	856-065-006	MICRO-SD CARD, <b>4GB</b> , AFIGUDI, ROHS
<b>OR</b>	856-065-007	MICRO-SD CARD, <b>8GB</b> , AFIGUDI, ROHS

## AC Cords

Regional Power Cords



AC Power - C13 Type Connector

PART NUMBER	DESCRIPTION
50117501-001	POWER CORD AUSTRALIA 2500MM,SLED CB
321-501-002	AC Power Cord, Denmark RoHS
77900508E	Cable: power cord, power supply to AC outlet, straight, Power cord, Europe EU, IEC320-C13, 2.5 m (8.2 ft)
321-502-002	AC Power Cord, India/S Africa RoHS
321-500-002	AC Power Cord, Japan RoHS
9000093CABLE	AC POWER CABLE, C14 TYPE, SWITZERLAND 3-PIN
77900507E	Cable: power cord, power supply to AC outlet, straight - Power cord, UK, IEC320-C13, 2.5 m (8.2 ft)
1-974028-025	AC Power Cord, US RoHS

# MISCELLANEOUS

## Disclaimer

---

Honeywell International Inc. (“HII”) reserves the right to make changes in specification and other information contained in this document without prior notice, and the reader should in all cases consult HII to determine whether any such changes have been made. The information in this publication does not represent a commitment on the part of HII.

HII shall not be liable for technical or editorial errors or omissions contained herein; nor for incidental or consequential damages resulting the furnishing, performance, or use of this material.

This document contains proprietary information that is protected by copyright. All rights are reserved. No part of this document may be photocopied, reproduced, or translated into another language with-out prior written consent of HII.

Web Address: [www.honeywellaidc.com](http://www.honeywellaidc.com)

The Bluetooth trademarks are owned by Bluetooth SIG, Inc., U.S.A and licensed to Honeywell.

Thor and Mobility Edge are trademarks or registered trademarks of Honeywell International Inc. in the United States and/or other countries.

Android is a trademark or registered trademark of Google Inc. in the United States and/or other countries. Windows is a trademark or registered trademark of Microsoft Corporation.

Qualcomm and Snapdragon are trademarks or registered trademarks of Qualcomm Incorporated in the United States and/or other countries.

Other product names mentioned in the manual may be trademarks of registered trademarks of their respective companies and are the property of their respective owners.

All rights reserved.

### For more information

[www.honeywellaidc.com](http://www.honeywellaidc.com)

### Honeywell Safety and Productivity Solutions

9680 Old Bailes Road

Fort Mill, SC 29707

800-582-4263

[www.honeywell.com](http://www.honeywell.com)